

Bluelink[®] App

User Manual (AUS) Version 1.3



Hyundai Bluelink[™]

The future at your fingertips.

Bluelink[®]

Contents

1. Login	3	5. Control	29	8. More	57
• Splash	4	• Main Screen	30	• Main screen	58
• Sign up & Verification	5	• EV Main Screen	31	• EV Main screen	59
• Find my ID and Reset password	7	• Remote Control	32	• Account setting	60
2. Select Vehicle	8	• Climate Control	33	• Vehicle & Service setting	61
3. Feature List	10	• Demister & Heating	34	• Vehicle Selection	63
4. Home	14	• Seat Settings	35	• App setting	64
• Bottom navigation	15	• Air Purifier System	36	• EV App Setting	65
• Helpful Hints	16	• Duration	37	• My Trips	66
• Main Screen	17	• EV Set Schedule	38	• EV Services	67
• Vehicle image and Vehicle Control	18	6. Status	41	• Alert Services	68
• EV Vehicle image and Vehicle Control	19	• Main screen & Car status	42	• Customer Service Center	72
• Vehicle Status	20	• EV Main Screen & Car Status	43		
• Map, My Vehicle Location	21	• Car Top view	44		
• My Calendar & Other	22	• Surround View Monitor	45		
• EV May Calendar & Other	23	7. Map	46		
• Engine (Charge) ON/OFF status	24	• Main screen	47		
• EV Charge Status	25	• Find my location	48		
• Remote Control	26	• Find my car	49		
• Find My Car	27	• Driving Distance Range	50		
• Edit Remote Control	28	• My Vehicle Location	51		
		• Previous	52		
		• Search nearby	53		
		• Search process	54		
		• Send to Car	55		





1. Login

- Splash Screen
- Sign Up Process
- Find my ID and Reset Password

1. Login > Splash Screen



1. Login > Sign up & Verification

- The Bluelink™ app can be used after creating an account.
- Create a password for the app and complete the onscreen details.
- You will need to verify your email address in order to set up account

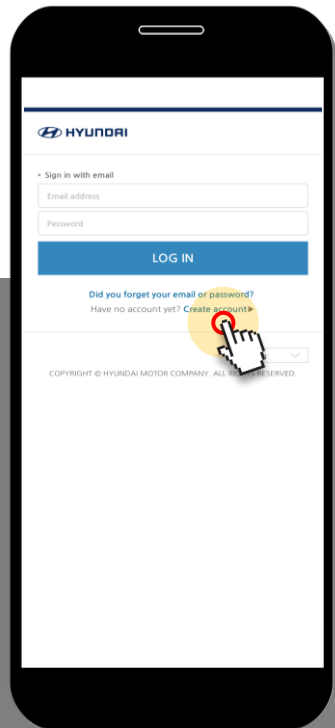

Create Account.

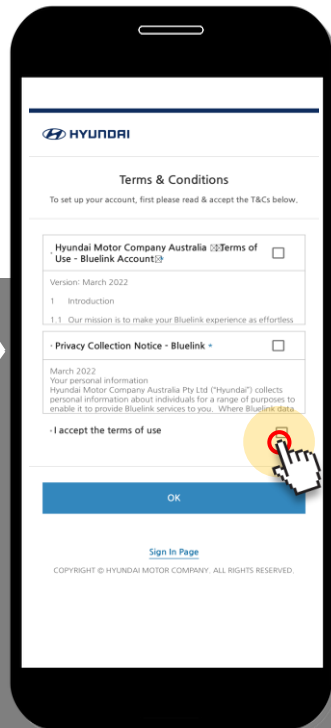

Terms and Condition.

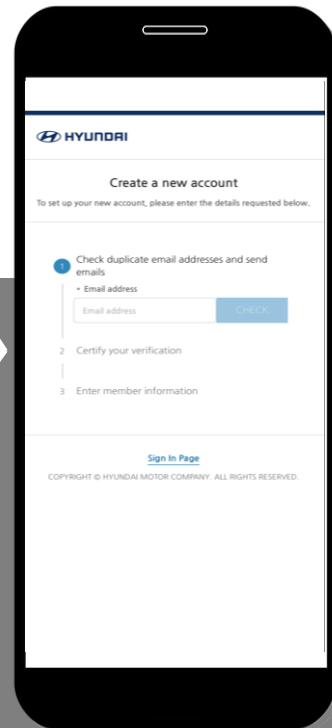

Create new account by entering your e-mail address.

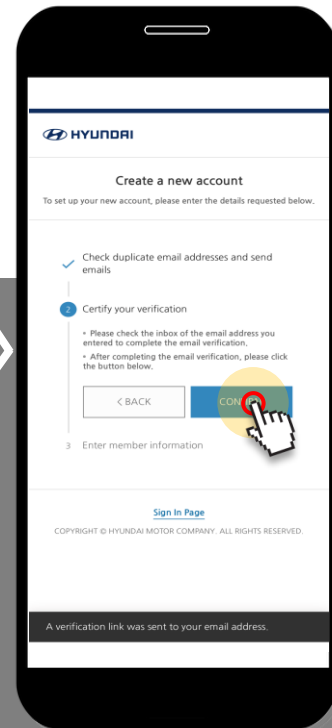

Verify e-mail address.

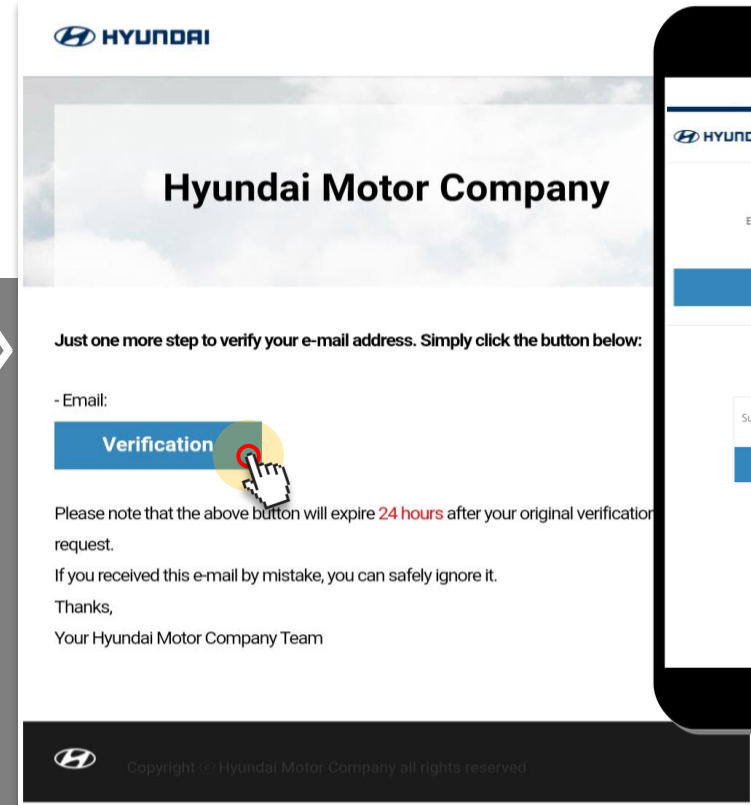

Open email and click 'Verification'
Toggle back to the Bluelink™ app and select 'OK'.

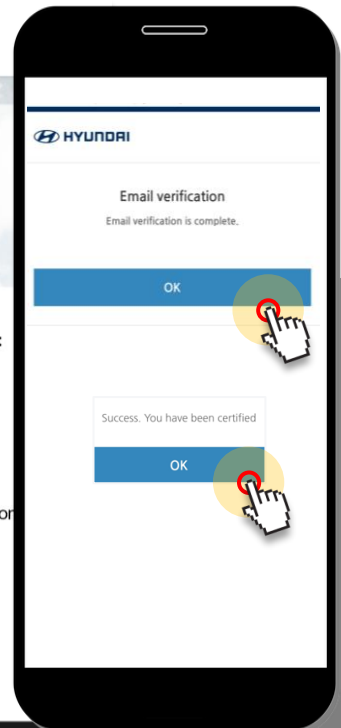

1. Login > Sign up & Verification

- The Bluelink™ app can be used after creating an account.
- Create a password for the app and complete the onscreen details.

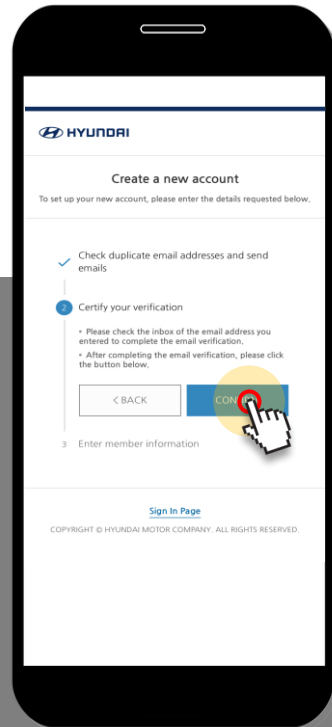

Continue with creating account.

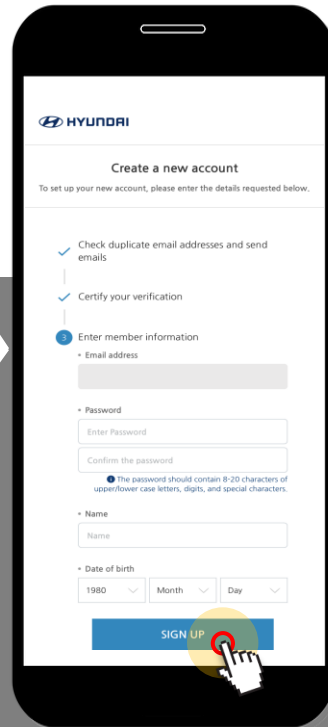

Set a password and complete the onscreen details.

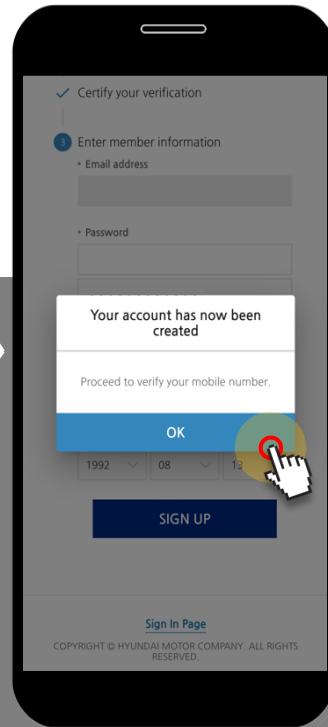

Account as successfully been created. Next is to set up mobile number and verify.

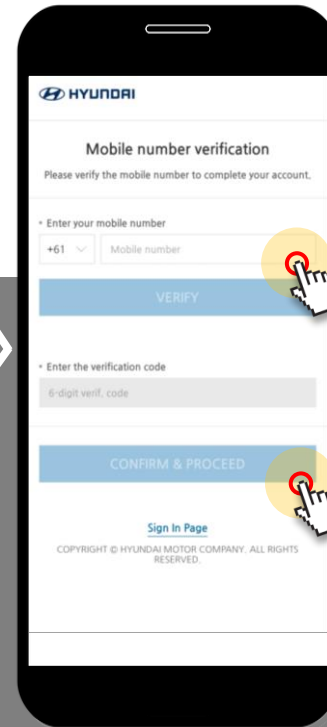

Enter mobile number and press verify. Enter the 6-digit code and confirm and proceed.

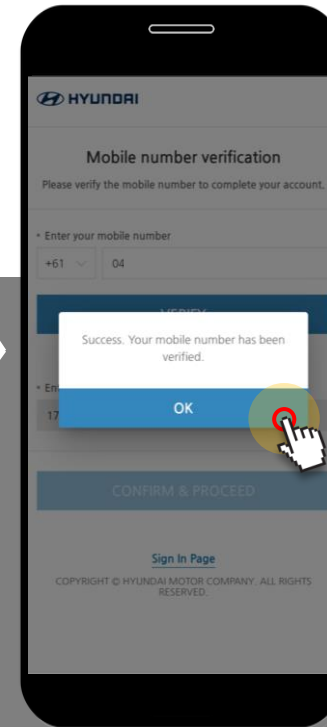

Your mobile number has now successfully been added to your account details.

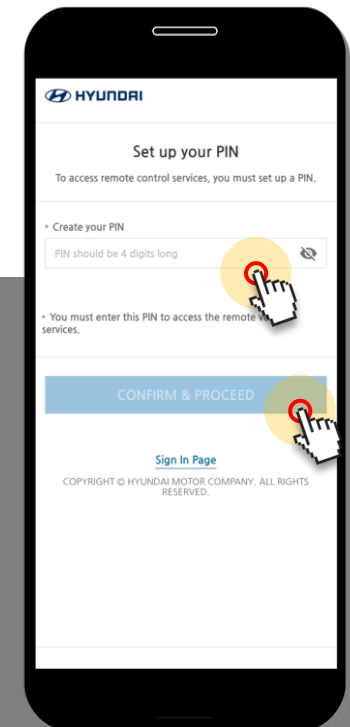

Lastly set up PIN number for approving remote features in the Bluelink™ App.

1. Login > Find my ID and Reset password

- If you forget your email or password, select the *'Did you forget your email or password'* option on the Login Screen.

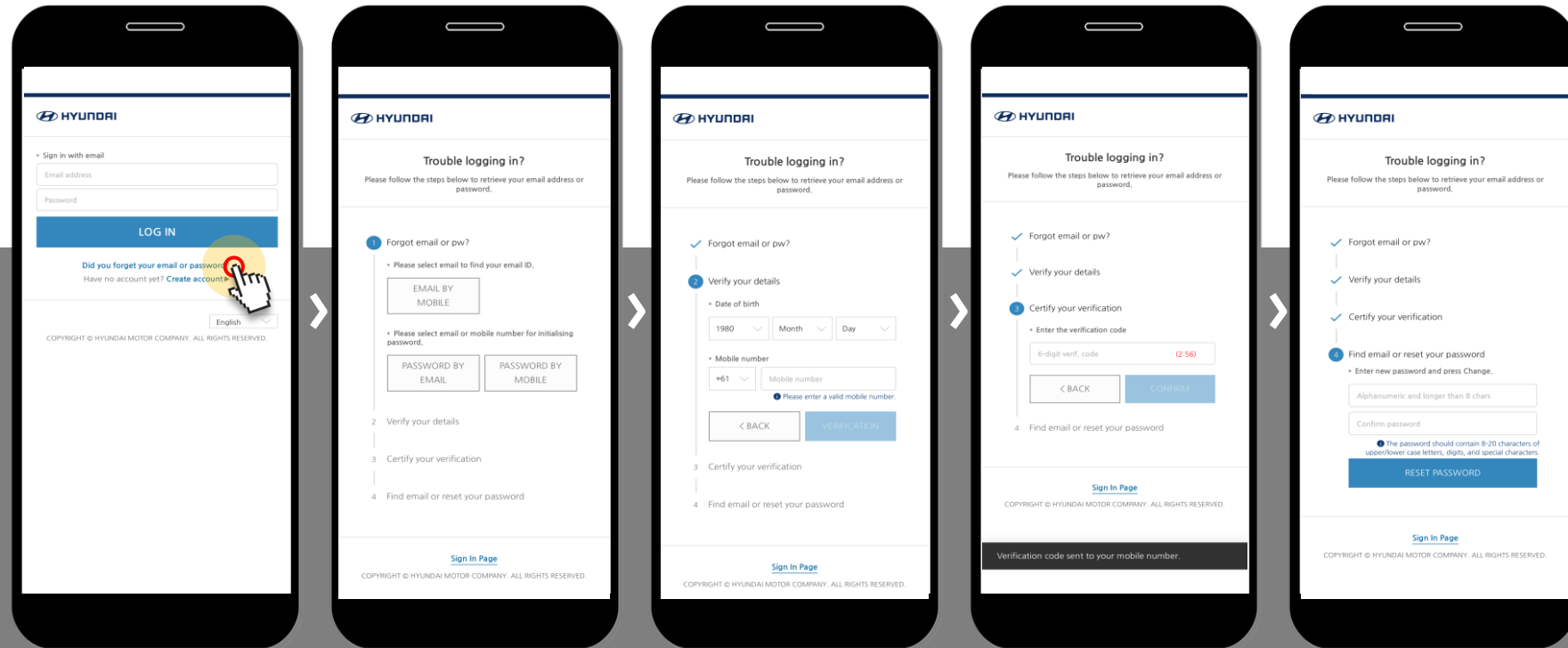

Forgot your email or password?

Select the desired option.

Verify your details.

Enter verification code.

Obtain login information or reset password.



2. Select Vehicle

2. Select Vehicle

- If this is the first time adding a vehicle, please see Bluelink™ Activation Guide.
- Once logged in, if you have already added your Hyundai previously, it will be listed.
- Select your Hyundai and you will be directed to the Home screen.

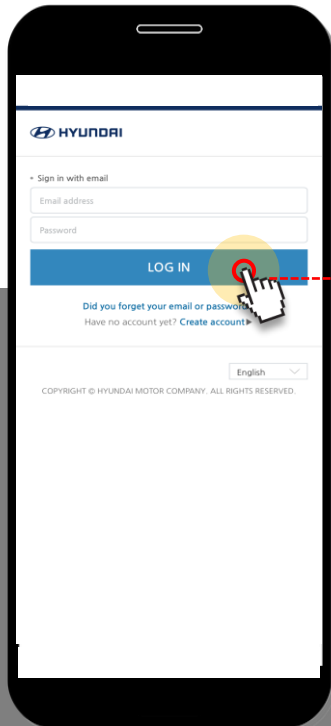

Login.

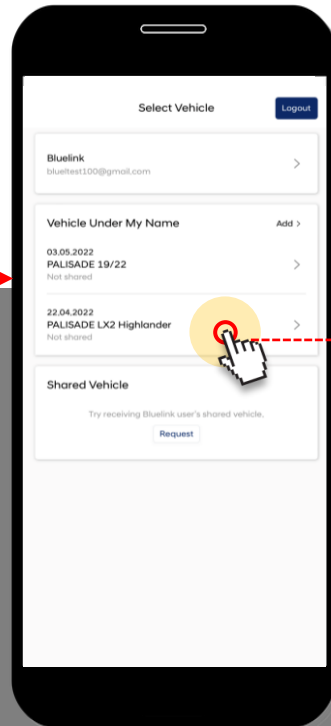

List of Registered Vehicles.

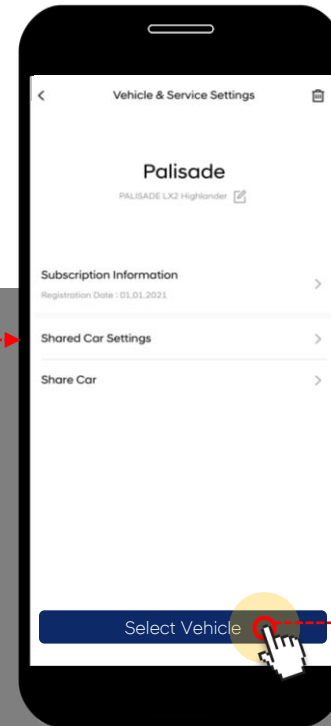

Select Vehicle.

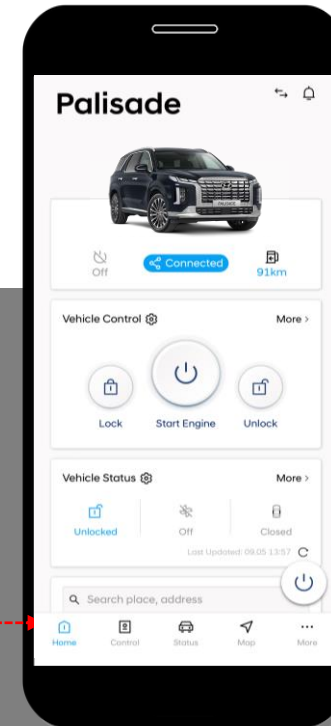

Bluelink™ is ready to use with your selected Hyundai.



3. Feature list

3. Feature List (1/3)

Category	Feature	Petrol/Diesel	Electric (EV)	
Vehicle & Service Setting	Vehicle Registration and Service Usage Settings	O	O	
First Run Setup	Vehicle Navigation First set-up	O	O	
Home	Vehicle Control Easy Remote Engine Start (On/Off)	O	X	
	Vehicle Control Easy Remote Start (Climate Control)	X	O	
	Vehicle Status (Last updated)	O	O	
	Map	O	O	
	Find My Car Location on the map	O	O	
	Search POI and Address	O	O	
	Calendar Service	O	O	
	Personalised Service Settings	O	O	
	User Profile Setting	O	O	
	My Trips	O	O	
	EV Service	X	O	
	Alert Services	O	O	
	Control	Start Engine / Stop Engine	O	X
		Lock Doors / Unlock doors	O	O
Start Climate Control / Stop Climate Control		X	O	
Start Charging / Stop Charging		X	O	
Open/Close Charging Port		X	O	
Open/Close Windows		O	O	
Ventilation & Curtain Setting		O	O	
Light		O	O	
Light/Horn		O	O	
Climate Settings		O	O	
Demister and Heat Setting		O	O	
Heated and Cooled Seats Setting		O	O	
Idle Duration Setting		O	O	
Set Scheduled (Charging and Climate Control)	X	O		

*All features may vary depending on vehicle model and trim level within ICE and EV vehicles.

3. Feature List (2/3)

Category	Feature	Petrol/Diesel	Electric
Status	Latest Vehicle Status Received	O	O
	Vehicle Top View	O	O
	Engine On/Off status	O	X
	Charging Status	X	O
	Climate Control status	O	O
	Locking status	O	O
	View Around My Vehicle (Surround View Monitoring)	O	O
	Fuel Gauge	O	X
	Range	O	O
	Others	O	O
	Warning Lamp Status	O	O
	Vehicle Management (Vehicle Health Report)	O	O
	Map	Control Map (Zoom in /Zoom out / Drag etc.)	O
Find My Car		O	O
Drivable distance radius		O	O
Nearby POI search		O	O
Recent Search		O	O
Favorite POI		O	O
Route Guidance		O	O
Send to Car		O	O

*All features may vary depending on vehicle model and trim level within ICE and EV vehicles.

3. Feature List (3/3)

Category	Feature	Petrol/Diesel	Electric
Miscellaneous	Guide Final Destination	0	0
	Valet Mode	0	0
	Sharing My Vehicle	0	0
	Latest Vehicle Status Received	0	0
	Account settings	0	0
	Vehicle & Service Settings	0	0
	Vehicle Selection	0	0
	App settings	0	0
	EV Services	X	0
	Customer Service Centre	0	0
	Widget - Remote Control	0	0
	Widget - Vehicle Status	0	0

*All features may vary depending on vehicle model and trim level within ICE and EV vehicles.



4. Home

- Bottom navigation
- Helpful Hints
- Main Screen
- Vehicle Image and Vehicle Control
- Vehicle Status
- Map, My Vehicle Location
- My Calendar
- Engine ON/OFF status /Charging status (EV Models only)
- Remote Control
- Find My Car
- EV Service (EV Models only)
- Edit Remote Control

4. Home > Bottom Navigation

- There are 5 main screens which can be accessed via the icons at the bottom of the screen or by simply swiping left or right.

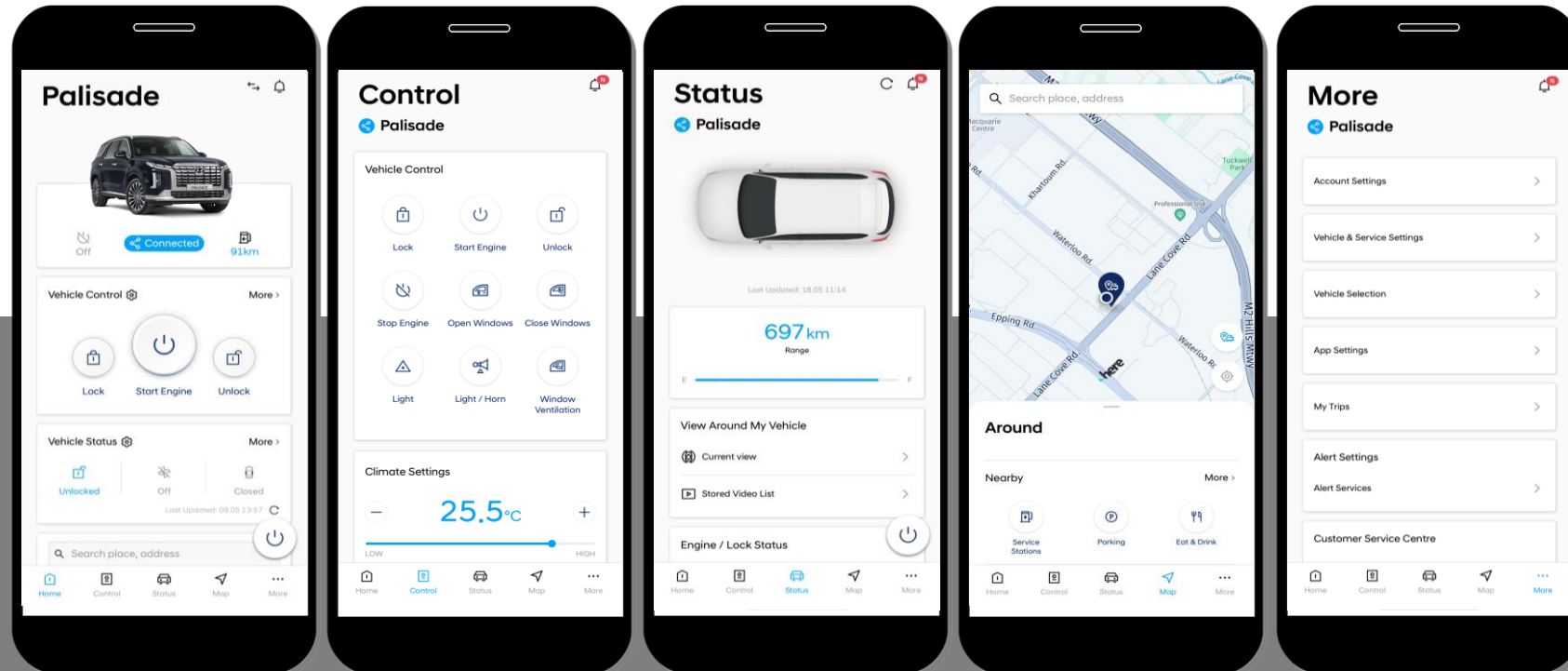

Home

Control

Status

Map

More

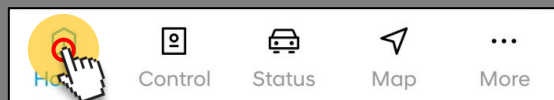

Select your desired menu via icons in the bottom navigation.

4. Home > Helpful Hints

- When entering the home screen, popups are displayed to give a brief description of the key features.

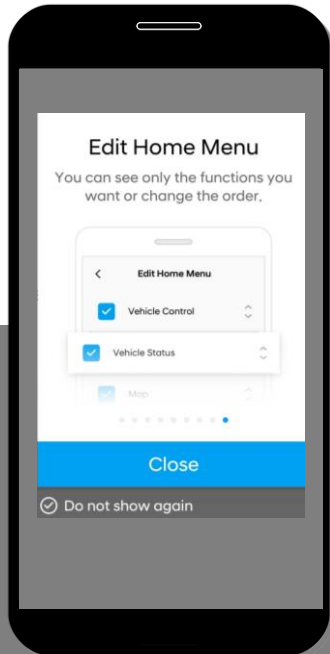

Edit Home Menu

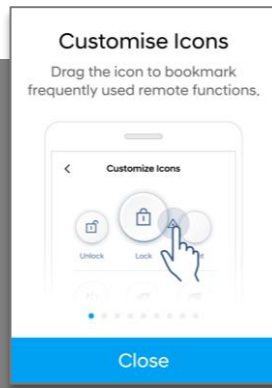

Customise Icons

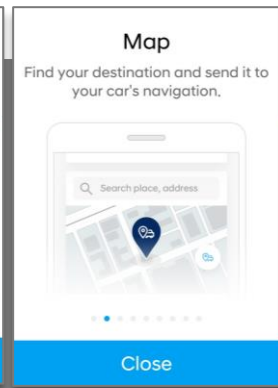

Map

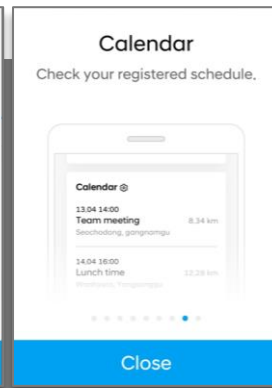

Calendar

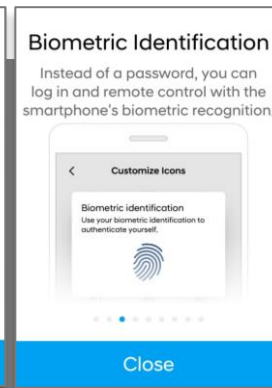

Fingerprint & Bio
Authentication

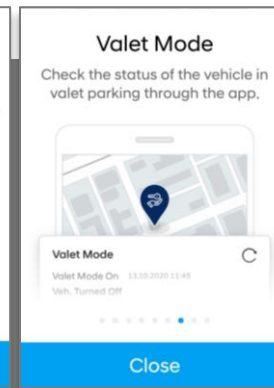

Valet Mode

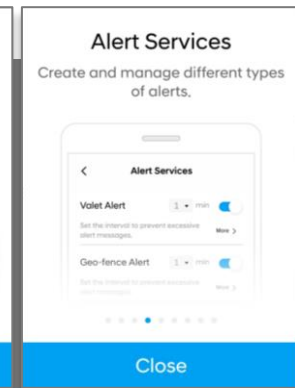

Alert Services

4. Home > Main Screen

- Once logged in, select your vehicle to open the home screen.
- You can customise the home screen to display the following features including,
 - Current status of the vehicle
 - Remote control buttons
 - Current location
 - Calendar and other services

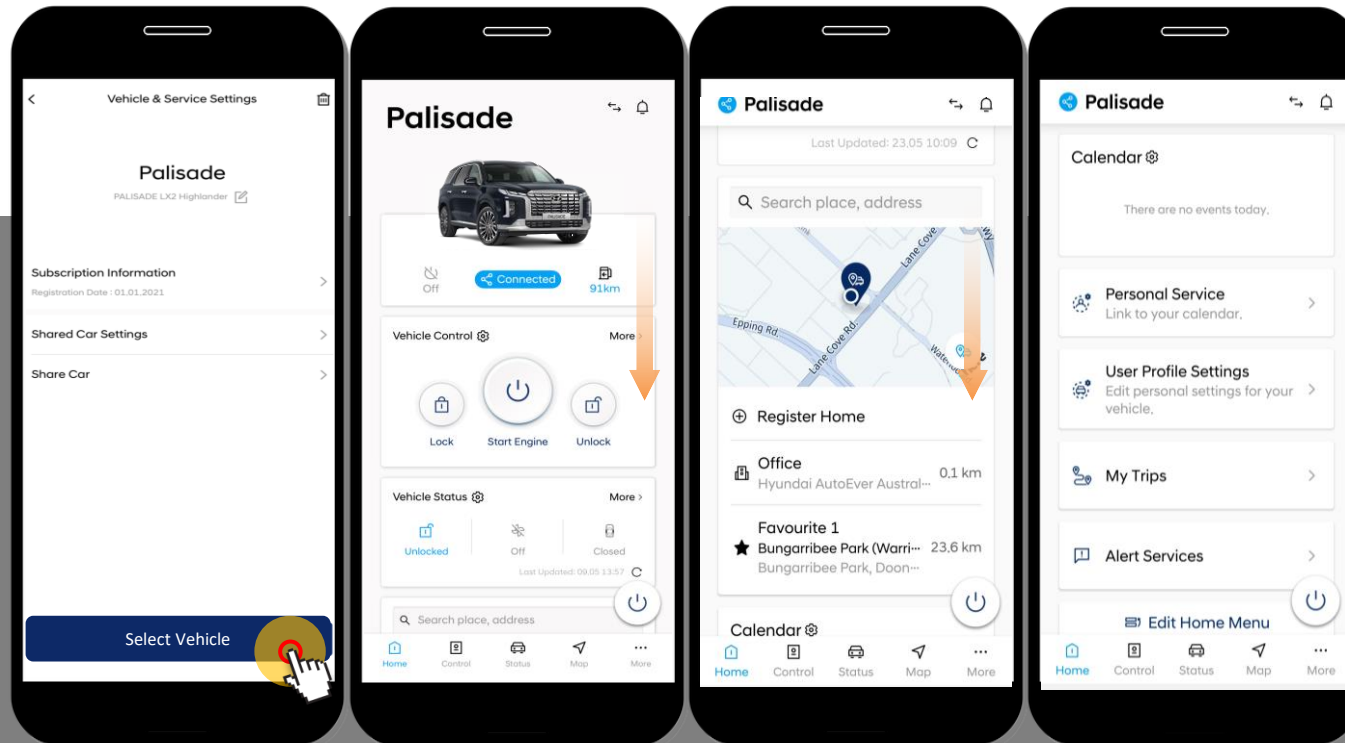

Select Vehicle.

Vehicle Control
& Status.

Map.

My Calendar
& Other Services.

5. Home > Vehicle Image and Vehicle Control

- Displays current vehicle status information (Engine on/off status and Distance to empty, etc.).
- Main remote functions (Start Engine, Lock & Unlock) can also be accessed.

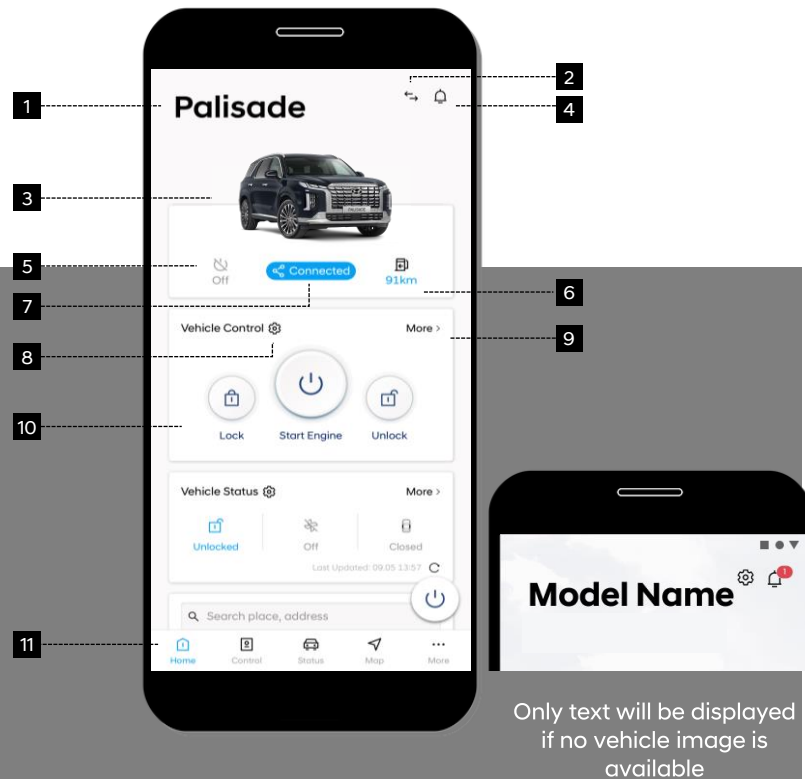

1	Vehicle Name	Your vehicle name
2	Change Vehicle	Change vehicle (If more than one vehicle is linked to the account)
3	Vehicle Image	Image of your Hyundai
4	Notification	Notifications list
5	Engine status	Engine ON/OFF status
6	Distance To Empty	Distance to empty
7	Connected Status	Connection status between vehicle and app
8	Customize Buttons	Change the order of the control buttons
9	More	See all vehicle control buttons
10	Main Vehicle Control	Main vehicle remote functions
11	Bottom Navigation	Menu navigation icons

5. Home > Vehicle Image and Vehicle Control

- Displays current vehicle status information (Climate on/off status, State of charge (EV Only), Distance to drive, etc.).
- Main remote functions (Start/Stop Charging, Lock & Unlock) can also be accessed.

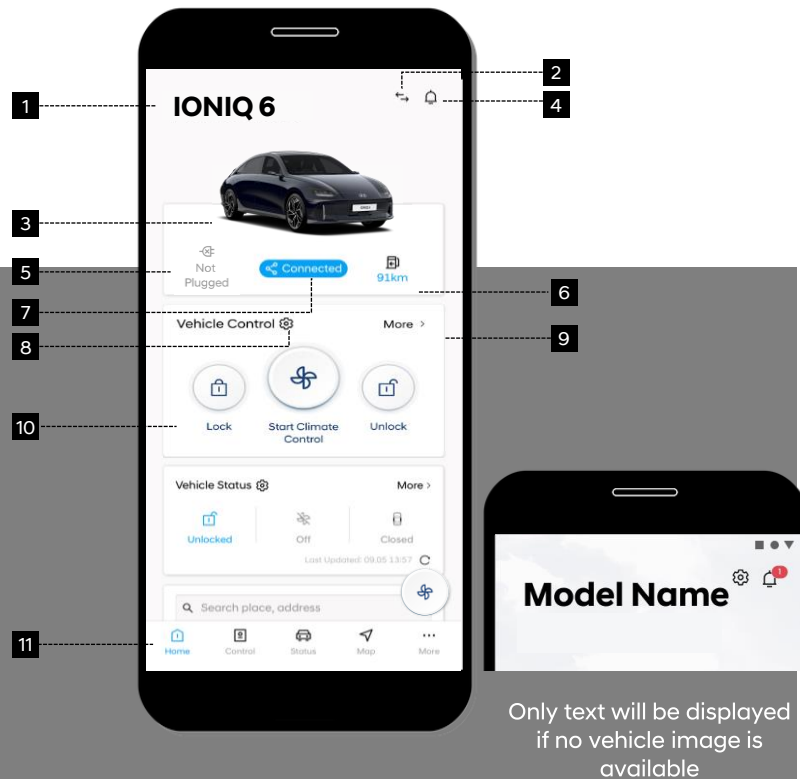

1	Vehicle Name	Your vehicle name
2	Change Vehicle	Change vehicle (If more than one vehicle is linked to the account)
3	Vehicle Image	Image of your Hyundai
4	Notification	Notifications list
5	Charge status	Charging, Not Plugged, Reserved status
6	Distance To Empty	Distance to empty
7	Connected Status	Connection status between vehicle and app
8	Customize Buttons	Change the order of the control buttons
9	More	See all vehicle control buttons
10	Main Vehicle Control	Main vehicle remote functions
11	Bottom Navigation	Menu navigation icons

4. Home > Vehicle Status

- The Vehicle Status allows you to select & view up to three vehicle statuses on the “Home Screen”

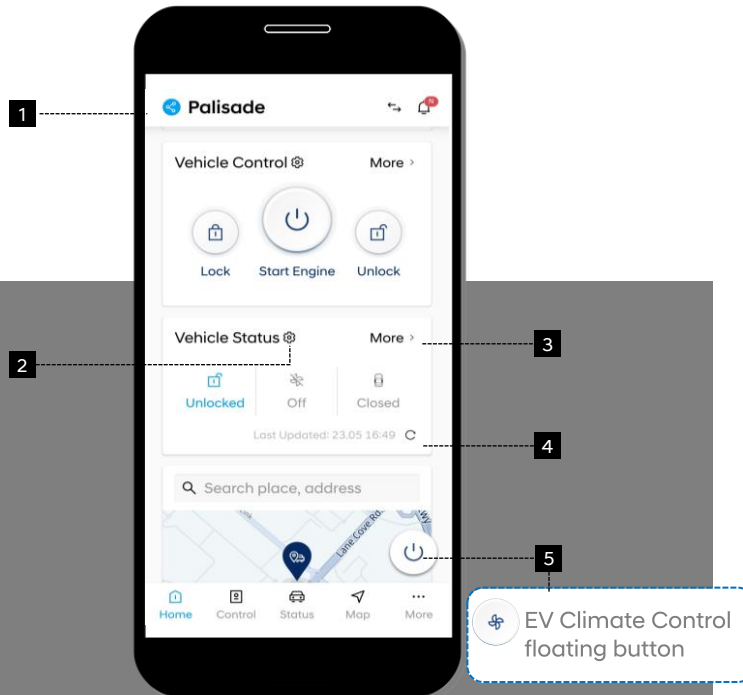

1 App Bar It is displayed when scrolling.

2 Edit My Vehicle Status Edit My Vehicle Status screens

UP 5:19 48%
< Edit My Vehicle Status **Reset**

You can change the status of up to 3 vehicles displayed on the home screen to other items.

- Choose to view only the items you want
- Depending on the option of the vehicle, the items may vary
- Press and hold to change the order

LOCK DOORS
 Climate Control
 DOOR

3 More See all Vehicle Status items

4 Refresh Refresh button for Vehicle Status

5 Floating button Short cut to remote Engine/Climate Control start (EV)

4. Home > Map, My Vehicle Location

- Search your destination via Maps
- If your vehicle is within 3 km, the map will display its location.
- Display up to three favorites.

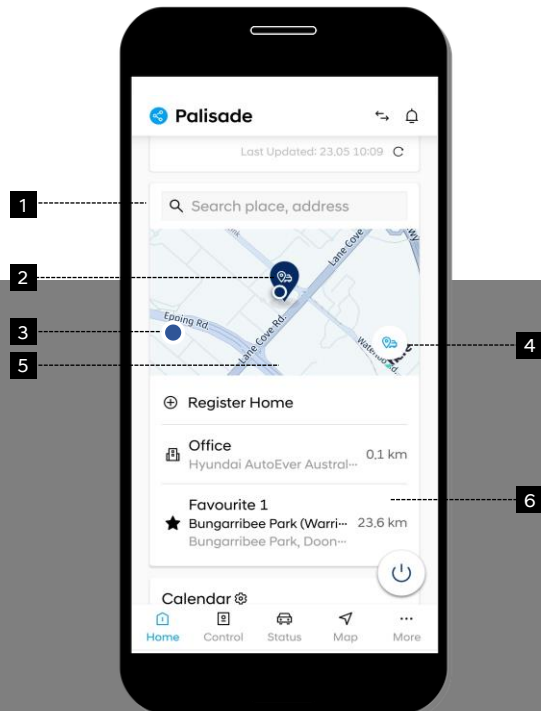

1	Search bar	Search a destination
2	My Car Location	Displays the position of my vehicle on the map
3	My Location	Displays the user's location based on GPS
4	Find My Car	Request button for Find My Car
5	Map	Map
6	Favorites	Displays a list of favorites registered by the user (up to three)

★ When linked to a vehicle

Displays a list of favorites registered in the vehicle navigation

★ When unlinked to a vehicle

Displays a list of favorites registered in app

4. Home > My Calendar and Other.

- The app displays the schedule that you saved in your smartphone's calendar.
- If your schedule contains location information, such as addresses, you can request a route navigation to that location via the 'Show Route' Button.

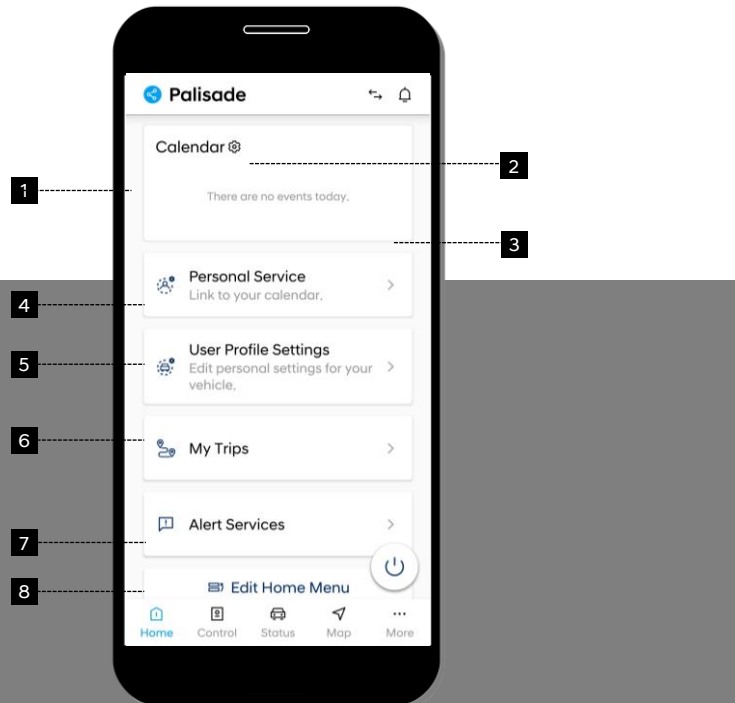

1	My Calendar	Show the schedule, time, and location
2	Setting	Edit my calendar
3	Show Route	Proceed with route search to the location registered on the schedule.
4	Personal Service	Links personal calendars which are not on your phone. (Includes: Google & iCloud Calendars)
5	User Profile Settings	Edit personal settings for your vehicle including: <ul style="list-style-type: none">• Profile Image• Backup your user profile• Vehicle settings• Driver account settings
6	My Trips	An overview of total Time/Distance/Avg & Top Speed.
7	Alert Services	Set your alerts for: <ul style="list-style-type: none">• Valet• Geo-fence• Speed• Time
8	Edit Home Menu	Select the items that will be displayed on the Home screen

4. Home > My Calendar and Other.

- The app displays the schedule that you saved in your smartphone's calendar.
- If your schedule contains location information, such as addresses, you can request a route navigation to that location via the 'Show Route' Button.

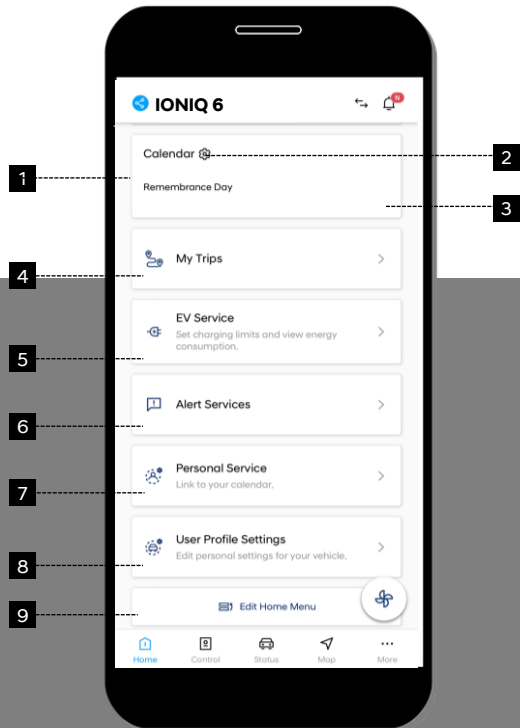

1	My Calendar	Show the schedule, time, and location
2	Setting	Edit my calendar
3	Show Route	Proceed with route search to the location registered on the schedule.
4	My Trips	An overview of total Time/Distance/Avg & Top Speed.
5	EV Service	Set charging limit (DC and AC) View energy consumption
6	Alert Services	Set your alerts for: <ul style="list-style-type: none">• Valet• Geo-fence• Speed• Time• Idle
7	Personal Service	Links personal calendars which are not on your phone. (Includes: Google & iCloud Calendars)
8	User Profile Settings	Edit personal settings for your vehicle including: <ul style="list-style-type: none">• Profile Image• Backup your user profile• Vehicle settings• Driver account settings
9	Edit Home Menu	Select the items that will be displayed on the Home screen

4. Home > Engine ON/OFF status

- The “Connected” icon allows you to check the connection between the vehicle and the app.

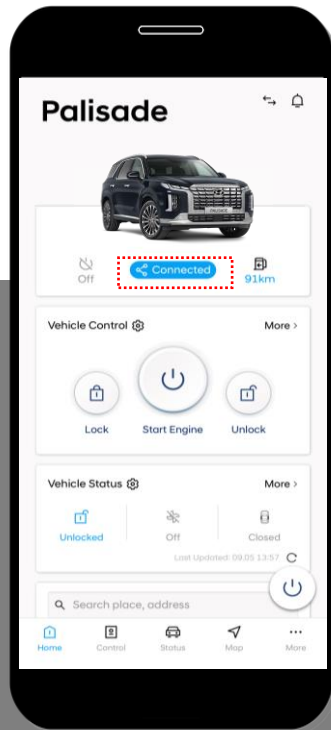

Disconnected

Connected

When the app is connected to the vehicle it will change from 'DISCONNECTED' to 'CONNECTED' icon.

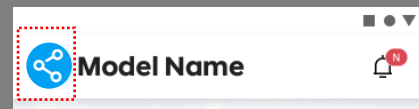

The app bar also displays an icon on the left side of the vehicle name.

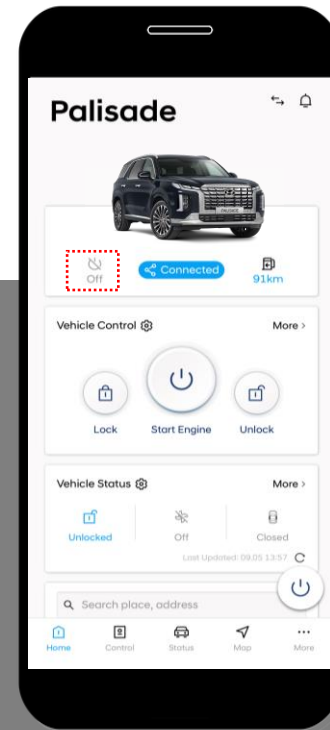

When the vehicle is switched on, the icon for the start state will blink. (In the case of an electric vehicle, it is displayed as a state of charge.)

4. Home > Charge status

- The “Connected” icon allows you to check the connection between the vehicle and the app.
- Charge status icons allows you to quickly reference what charging status your vehicle is up to.

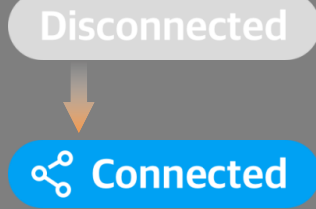
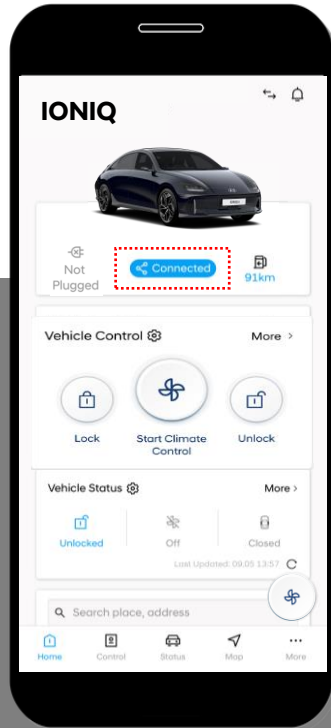

When the app is connected to the vehicle it will change from 'DISCONNECTED' to 'CONNECTED' icon.

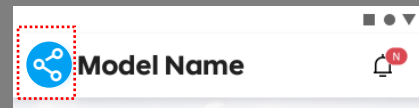

The app bar also displays an icon on the left side of the vehicle name.

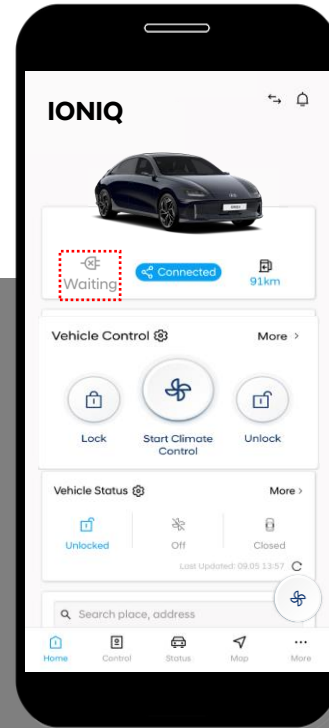

The charge status icon will change depending on what state of charge the vehicle is in.

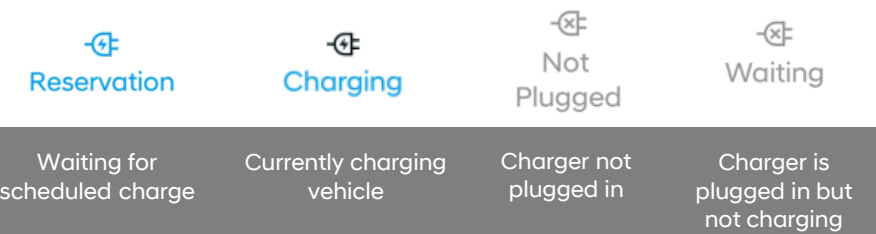

4. Home > Remote Control

- Select the desired remote function icon on the vehicle control menu.
- Enter the PIN & confirm
- Selected remote function icon flashes while the command is sent to the vehicle.
- Once complete the result is displayed.

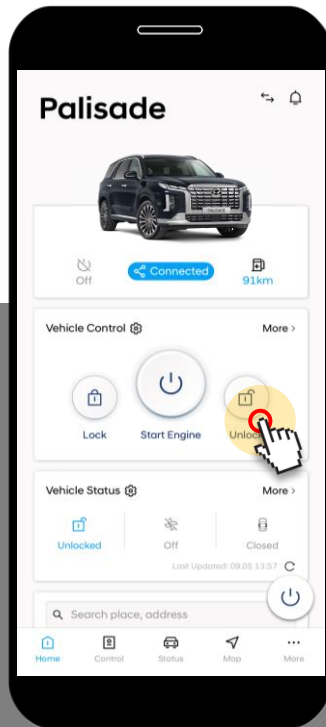

Select desired remote control button.

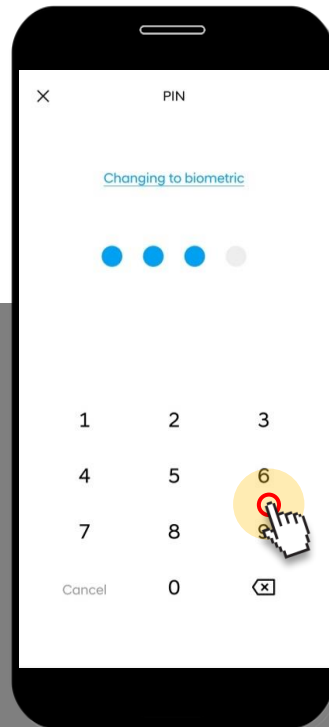

Enter PIN.

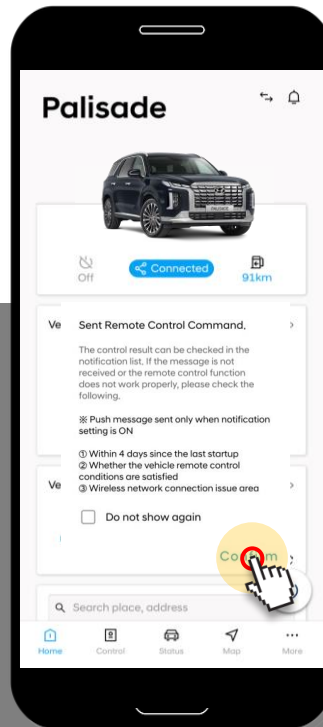

Confirm Remote function .

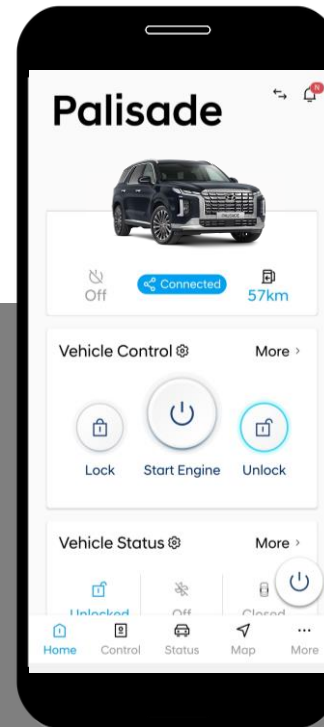

Button flashes while connecting to the vehicle.

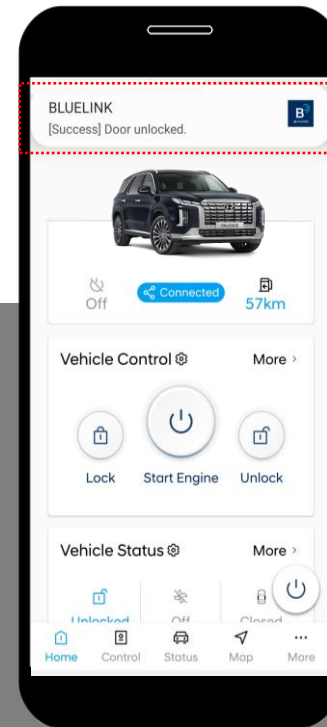

Once completed success message appears.

4. Home > Find My Car

- To display the location of your vehicle on the map, select the 'Find My Car' button and enter your PIN code.
- Displays only if the vehicle position is within 3 km of the current GPS position of the smartphone.

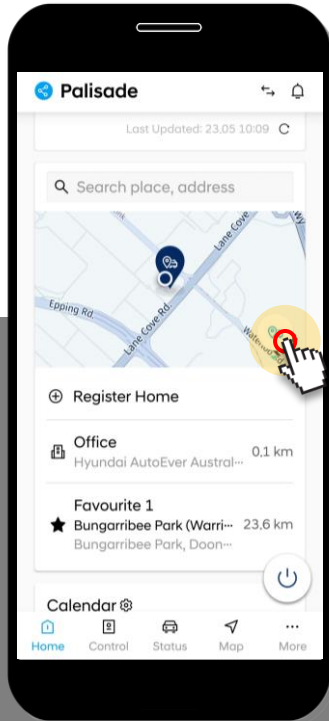

Select 'Find My Car' icon.

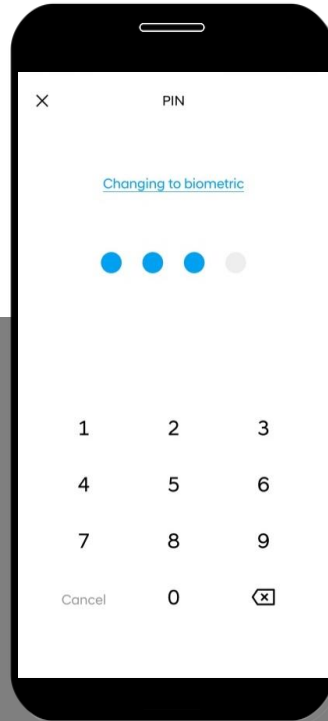

Enter PIN.

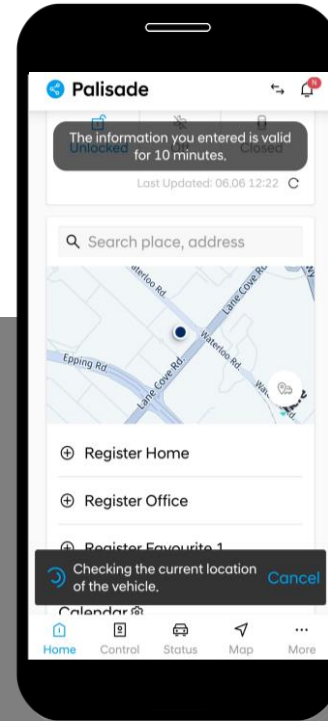

Checking vehicle location.

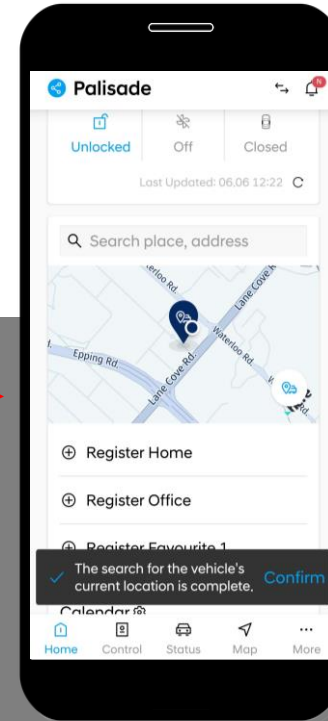

Find my vehicle location is marked on the map.

4. Home > Edit Remote Control

- You can edit the “Home” screen with the remote button features you prefer.
- Press and hold the required remote-control button to move it to the desired position.

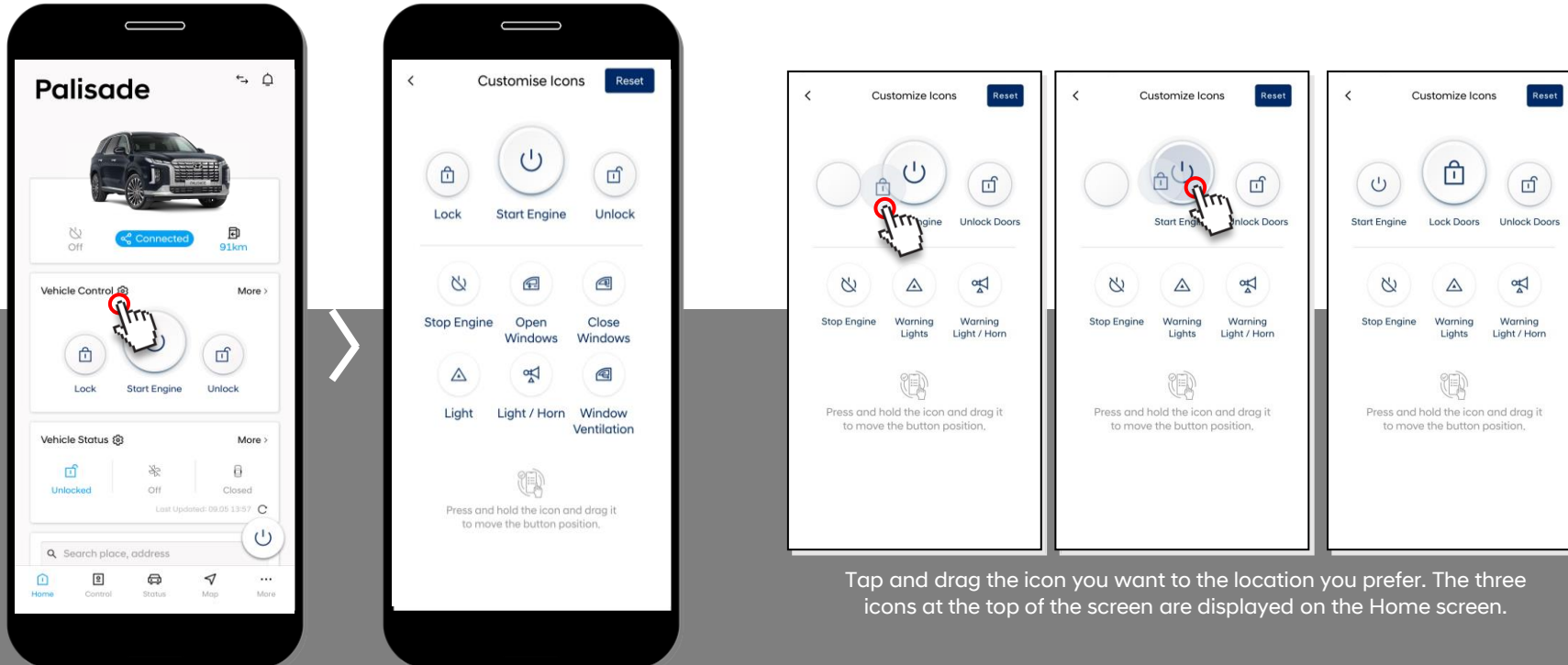



5. Control

- Main Screen
- Remote Control
- Climate Setting
- Demister/Heating
- Seat Setting
- Air Purifier System
- Duration
- Set Schedule (EV models only)

5. Control > Main Screen

- Various vehicle controls are available remotely. Temperature, Demister/heating, and Idle Duration can be set when requesting remote start. Remote Control Features may vary depending on the vehicle's options.

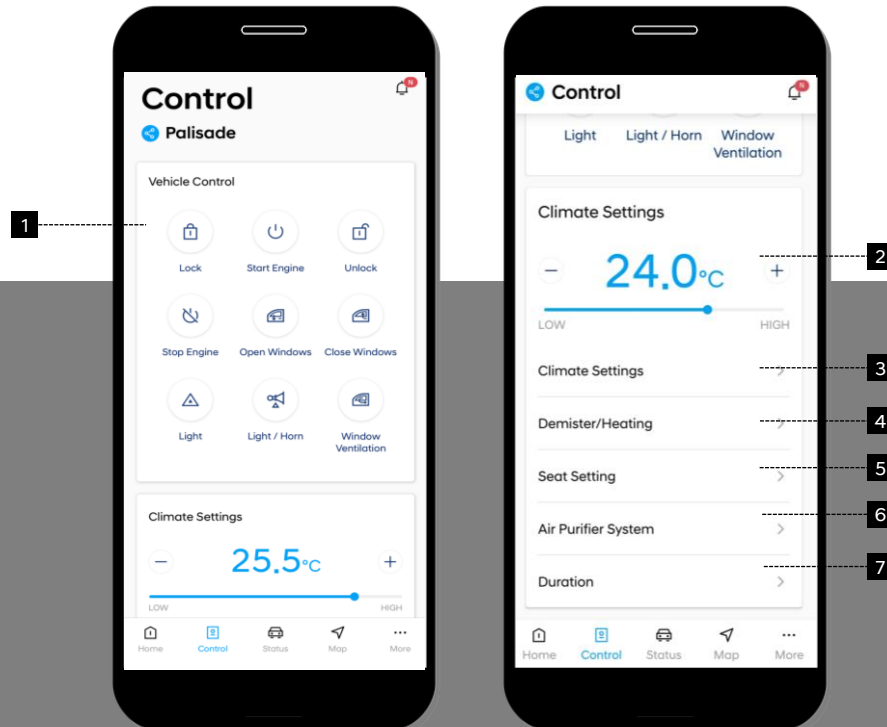

- | | | |
|----------|-------------------------------|--|
| 1 | Control | Available remote-control buttons

Control buttons vary depending on vehicle options |
| 2 | Temperature | Adjust the temperature to your desired level when starting the engine.

The temperature value can be adjusted by pressing the (-),(+) buttons or by the slide bar. |
| 3 | Climate Settings | Start engine with Air Conditioning On/Off or last set temperature. |
| 4 | Demister & Heating | Set Front/Rear windscreen demister, Side mirror heat and etc. |
| 5 | Seat Setting | Seat settings for Heated and Ventilation seats (were fitted). |
| 6 | Air Purifier System | Start engine with Air Purifier On/Off (were fitted). |
| 7 | Duration | Set engine idle time between 2 and 10 minutes. |

5. Control > Main Screen

- Various vehicle controls are available remotely. Temperature and Demister/heating can be set when requesting remote Climate Control. Remote Control Features may vary depending on the vehicle's options.
- Set Schedule charging based on Next Departure Time, Off-peak Tariffs and set Target Temperature for cabin.

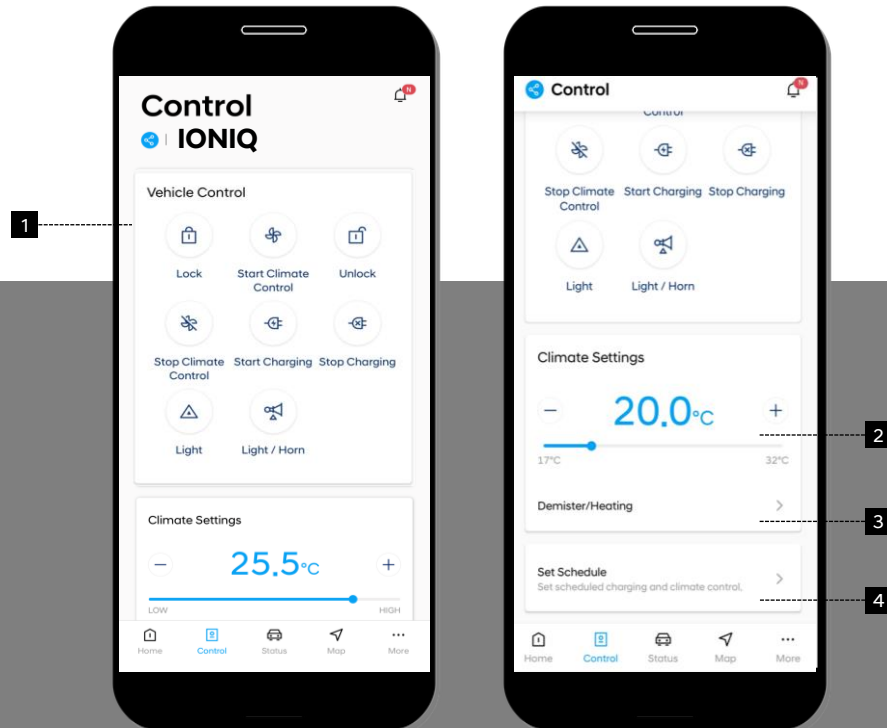

1 Control Available remote-control buttons
Control buttons vary depending on vehicle options

2 Temperature Adjust the temperature to your desired level when starting Climate Control.
The temperature value can be adjusted by pressing the (-),(+) buttons or by the slide bar.

3 Demister & Heating Set Front/Rear windscreen demister, Side mirror heat and etc.

4 Set Schedule Set scheduled charging and climate control settings for departure.

5. Control > Remote Control

- Select the desired remote function icon on the vehicle control menu.
- Enter the PIN & confirm
- Selected remote function icon flashes while the command is sent to the vehicle.
- Once complete the result is displayed.

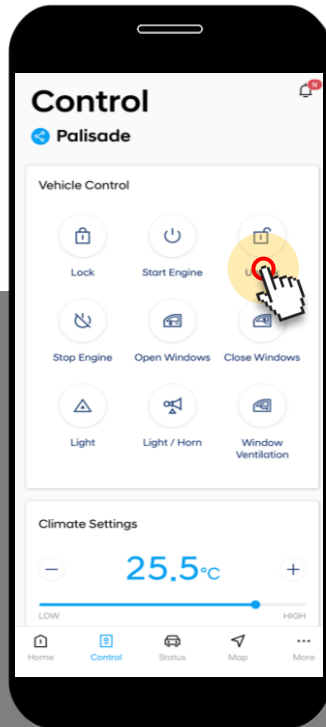

Select desired remote control button.

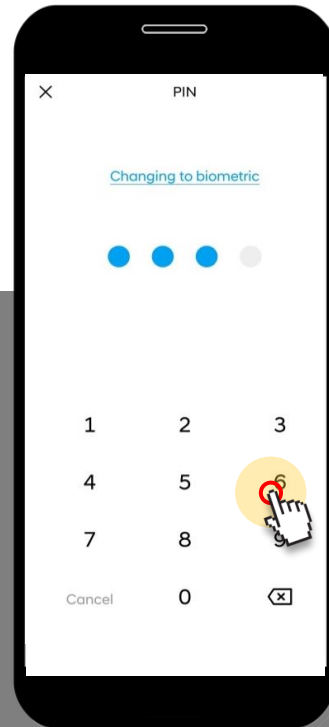

Enter PIN.

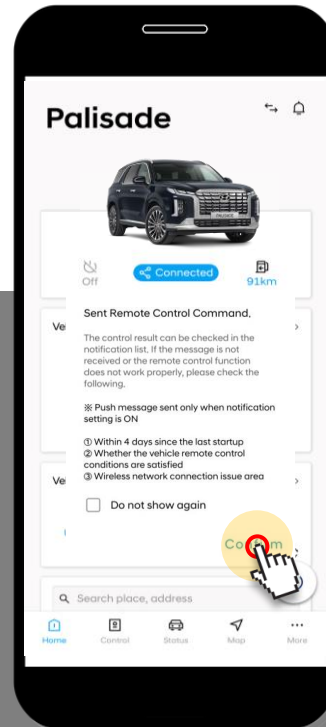

Confirm Remote function.

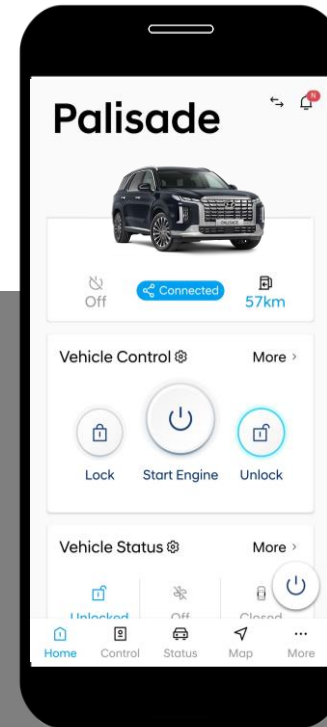

Button flashes while connecting to the vehicle.

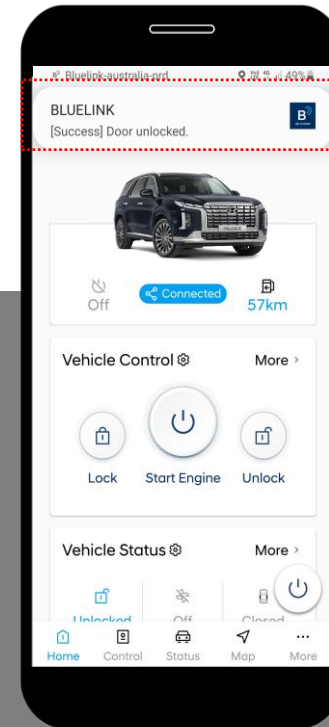

Once completed success message appears.

5. Control > Climate Settings

- You can set the desired temperature when remote starting your vehicle.

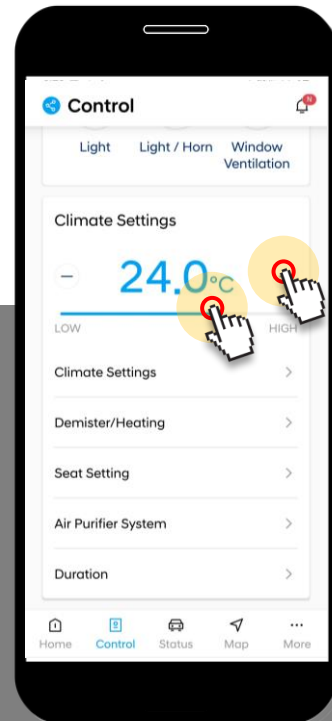

The temperature can be adjusted by pressing the (-) or (+) buttons or by the side bar.

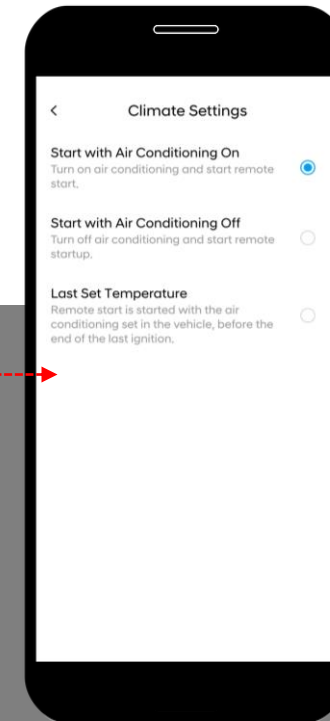
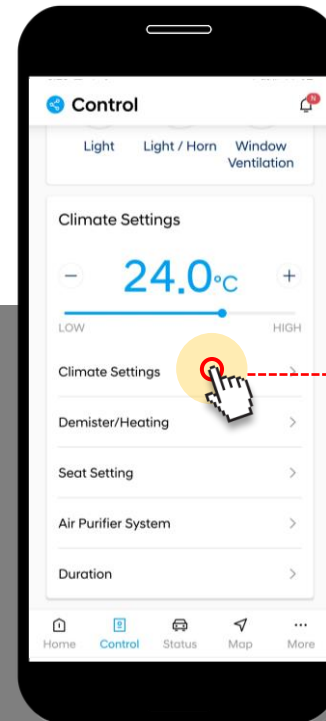

Start engine with Air Conditioning On/Off or last set temperature.

5. Control > Demister/Heating

- Select whether you want Side Mirrors + Rear Window Demister and Steering Wheel Heating on when requesting remote control Climate.

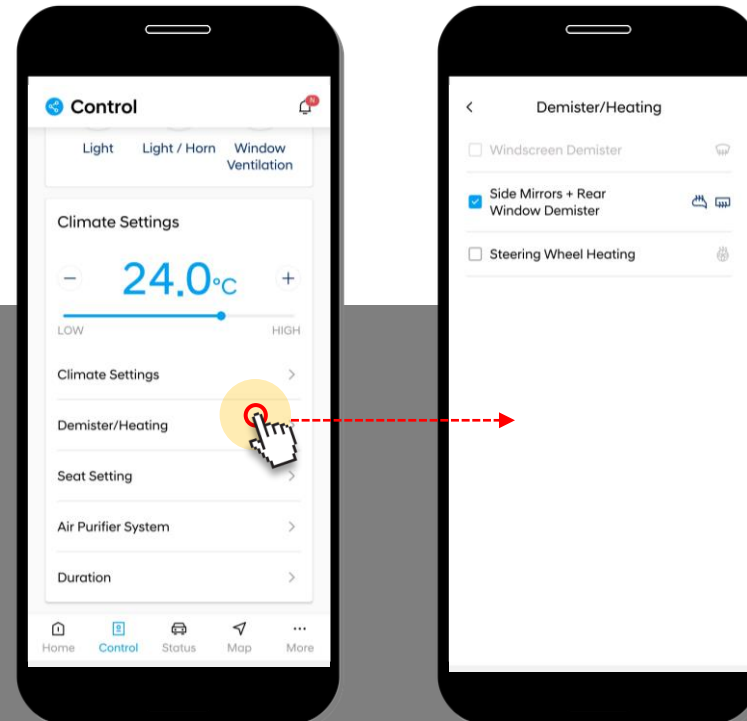

Front/Rear windscreen demister and heated steering wheel and heated side mirror can be set.

5. Control > Seat Setting

- Select whether you want vented or heated seats on during remote engine startup. (Only for models with vented or heated seats fitted)

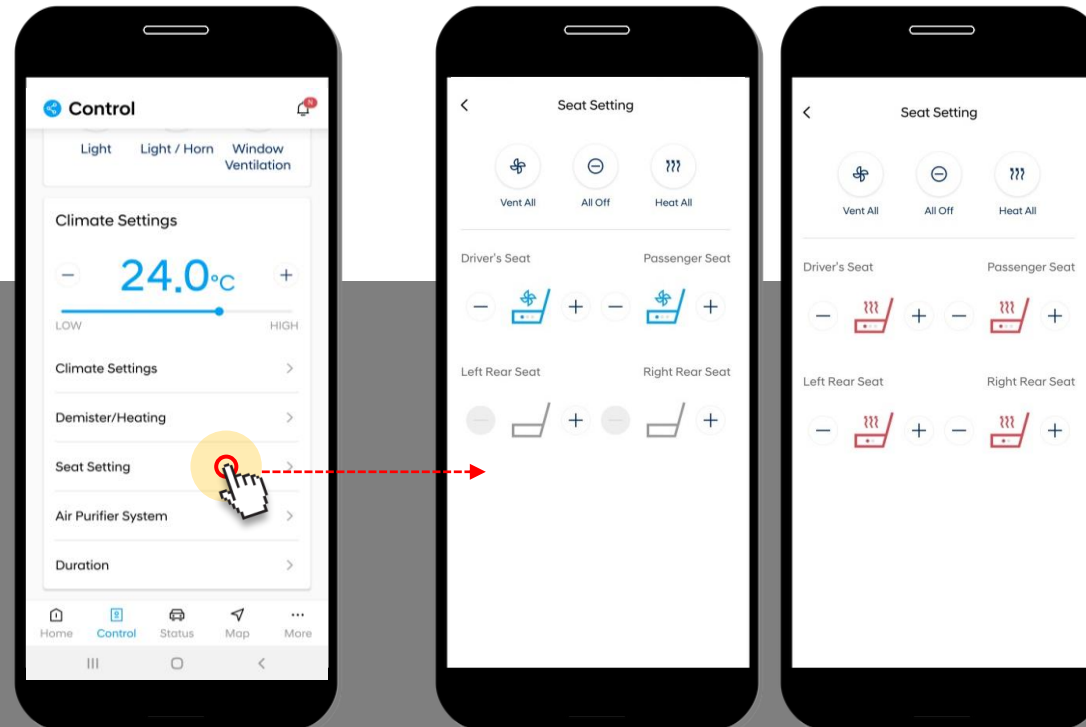

5. Control > Air Purifier System (Only for models with an Air Purifier fitted).

- You can choose to have the vehicle's Air Purifier On/Off during remote engine startup. (Only for models with an Air Purifier fitted).

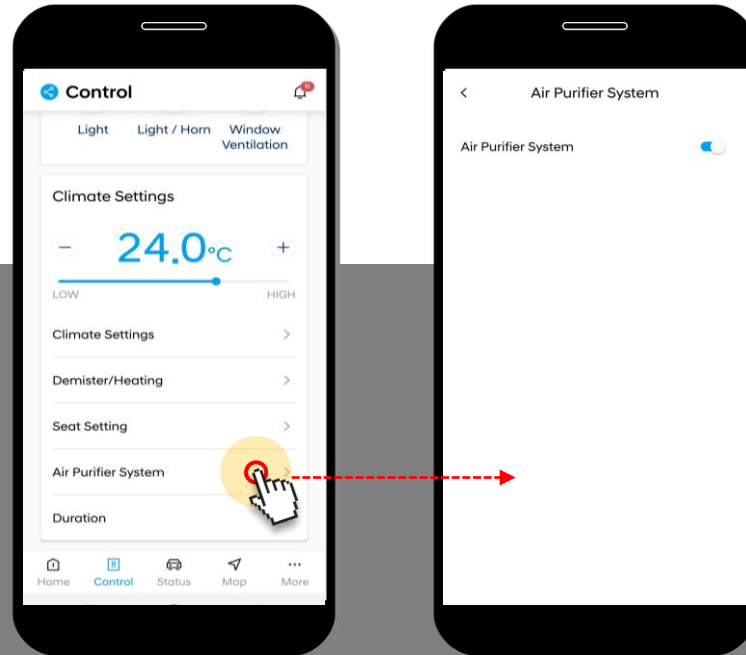

5. Control > Duration

- You can set the idle time duration after remote starting to be between 2 to 10 minutes.
- You can change the idle time by pressing the - or + button or by moving the slide bar.

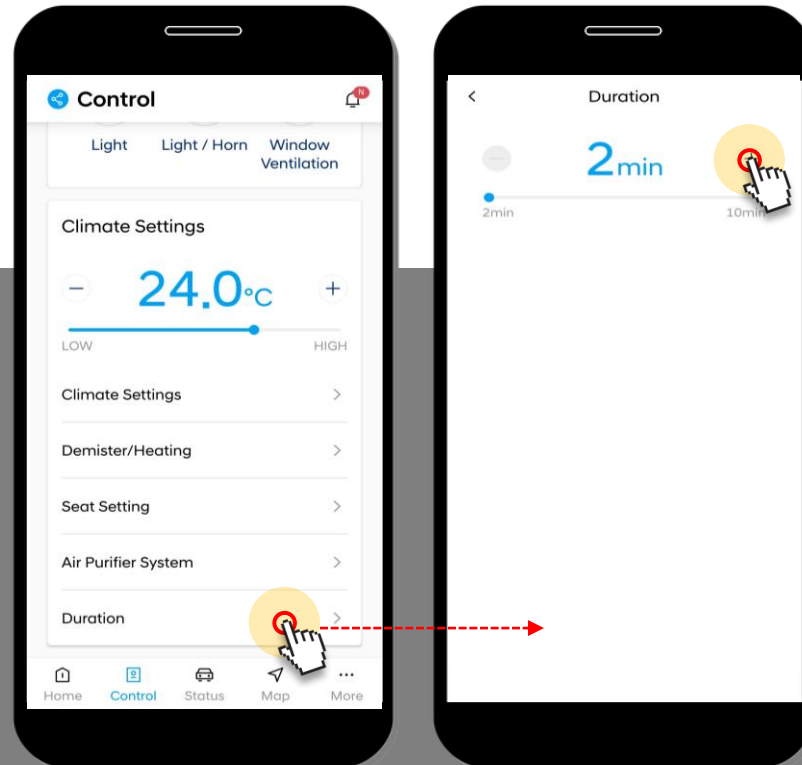

5. Set Schedule > Next Departure Time

Scheduled charging and target temperature will be activated according to departure time. Charging time may vary depending on charging conditions.

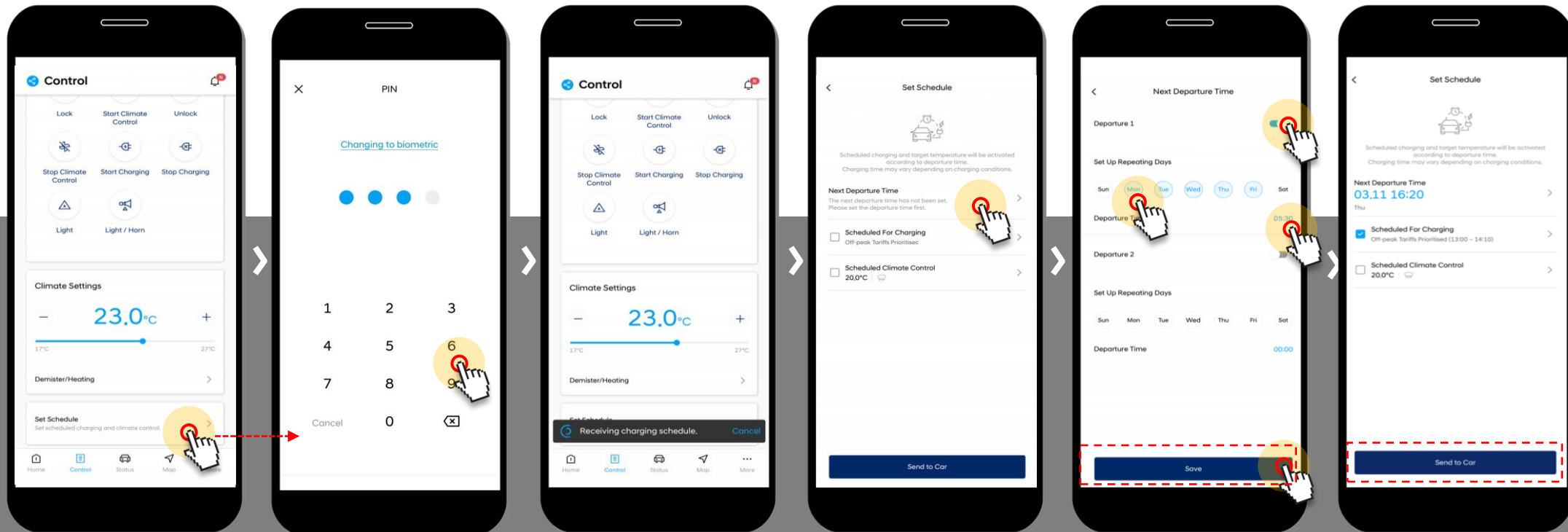

Select set schedule.

Enter PIN.

Displays pop up message while searching.

Select Next Departure Time.

Set up departure time for recurring days-

If finished customizing, select Send to Car.

✓ Reservation information setup command is sent. The results can be checked with push notifications. **Confirm**

Pop up message displays to confirm vehicle search is complete

- Enable Departure setting
- Select days
- Select departing time
- Select save

5. Set Schedule > Schedule For Charging

Scheduled charging and target temperature will be activated according to departure time. Make use of Off-peak Tariffs by scheduling charging time during this time either Off-peak Tariffs Prioritised or Off-peak Tariff Only (Charging time may vary depending on charging conditions).

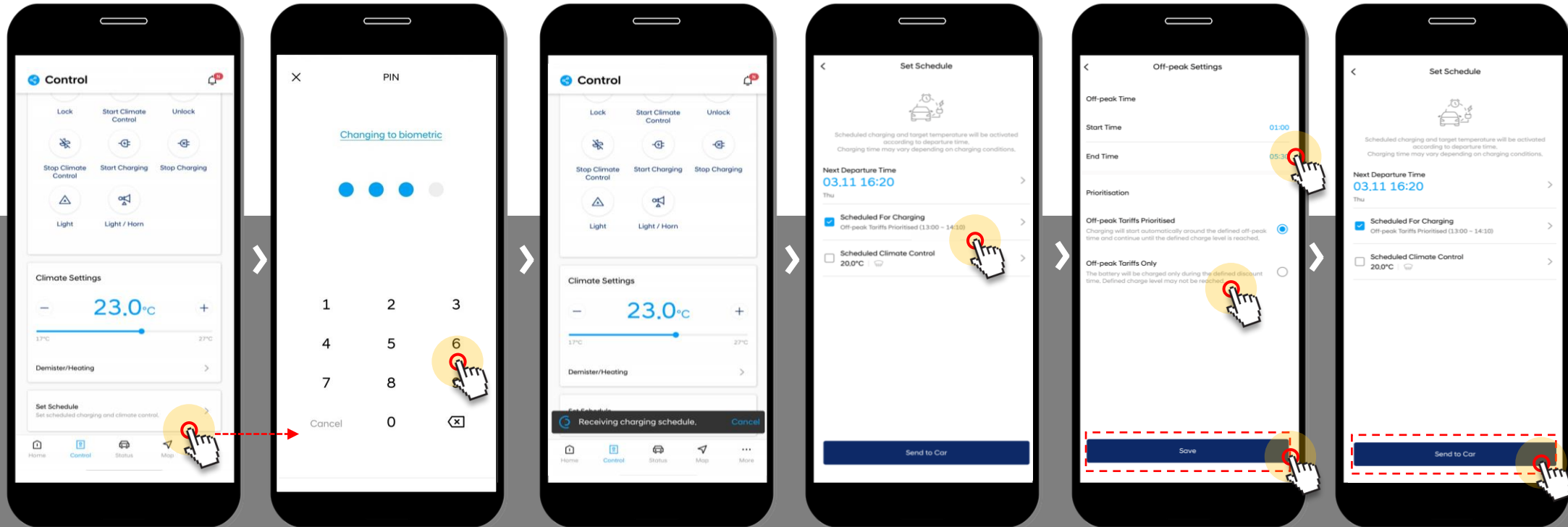

Select set schedule.

Enter PIN.

Displays pop up message while searching.

Select Scheduled for Charging.

Set up Off-Peak Settings-

- Select start & end times
- Select either Off-peak tariffs Prioritized or Off-peak tariffs only
- Select Save

If finished customizing, select Send to Car.

✓ Reservation information setup command is sent. The results can be checked with push notifications. **Confirm**

Pop up message displays to confirm vehicle search is complete

5. Set Schedule > Schedule For Climate Control

Scheduled charging and target temperature will be activated according to departure time. The target temperature will be reached 30 minutes before the departure time.

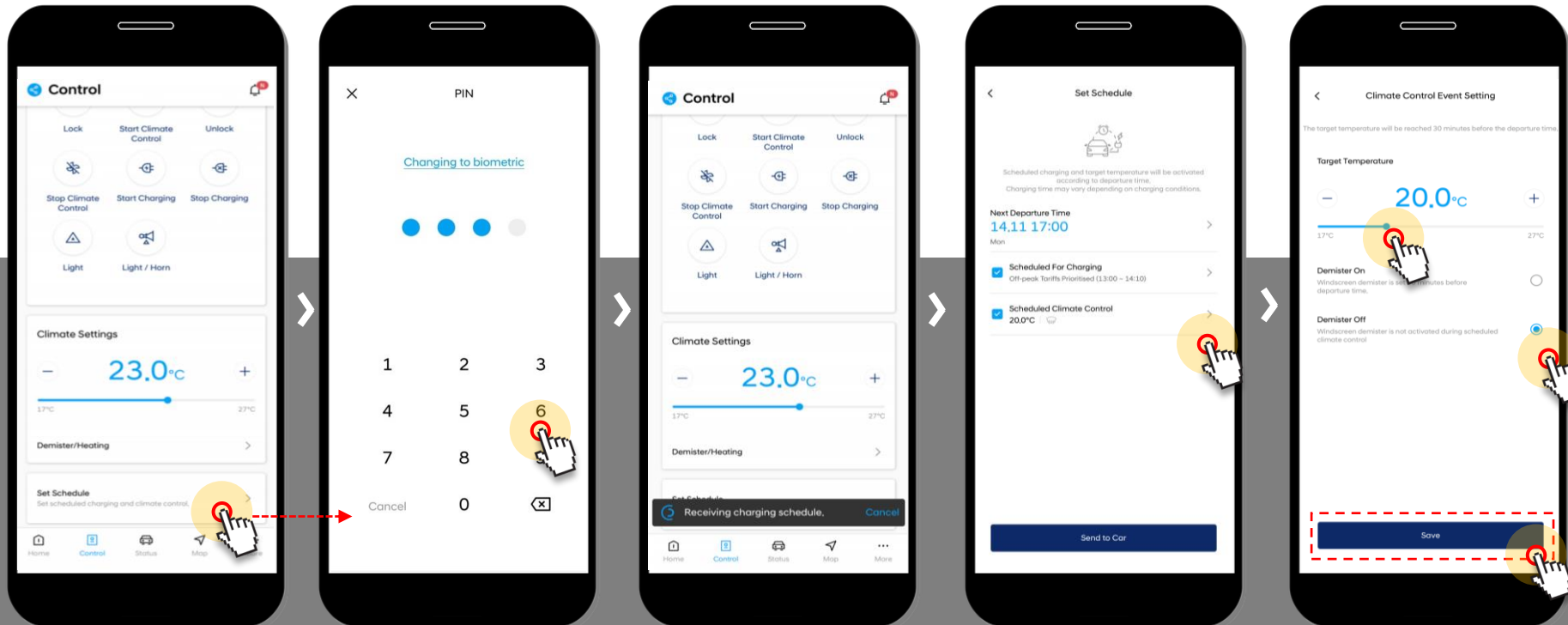

Select set schedule.

Enter PIN.

Displays pop up message while searching.

Select Scheduled Climate Control.

Set up desired temperature
Set demisters On/Off
Send to car

✓ Reservation information setup command is sent. The results can be checked with push notifications. **Confirm**

Pop up message displays to confirm vehicle search is complete



6. Status

- Main screen & Car status
- Car top view
- Surround view monitor

6. Status > Main screen and Car status

- A menu that displays the status of the vehicle, provides vehicle status information within the range of supported options through the top view of the vehicle and status icons for each function.

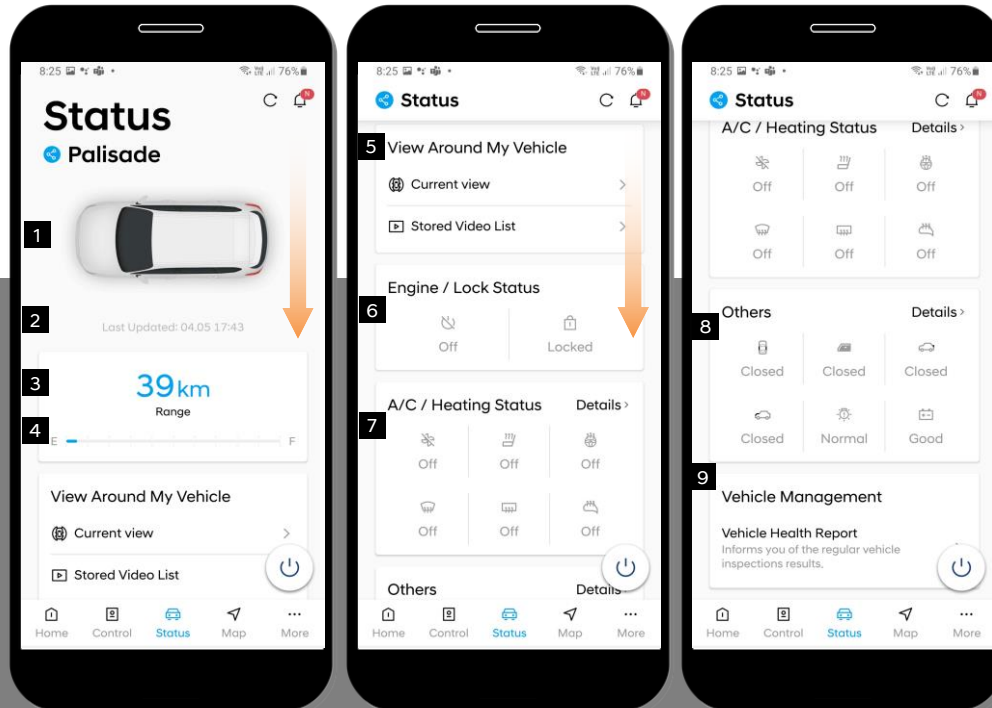

1	Vehicle status top view	Display the customer's current vehicle status in a top view
2	Last Update	Displays the date the vehicle status was last updated
3	Range	Displays the vehicles range based on the amount of fuel remaining
4	Amount of fuel remaining	Displays amount of fuel remaining and gauge
5	View Around My Vehicle	If cameras are fitted to your vehicle, it will record a 360-degree view around the vehicle.
6	Engine/Lock status	Displays vehicle start engine/door lock status
7	A/C & Heated Seat Status	Displays vehicle temperature/ heated seat & demister status
8	Other	Displays status of vehicle doors, sunroof, bonnet, etc.
9	Vehicle Management	Report providing monthly vehicle Health and Status information

6. Status > Main screen and Car status

- A menu that displays the status of the vehicle, provides vehicle status information within the range of supported options through the top view of the vehicle and status icons for each function.

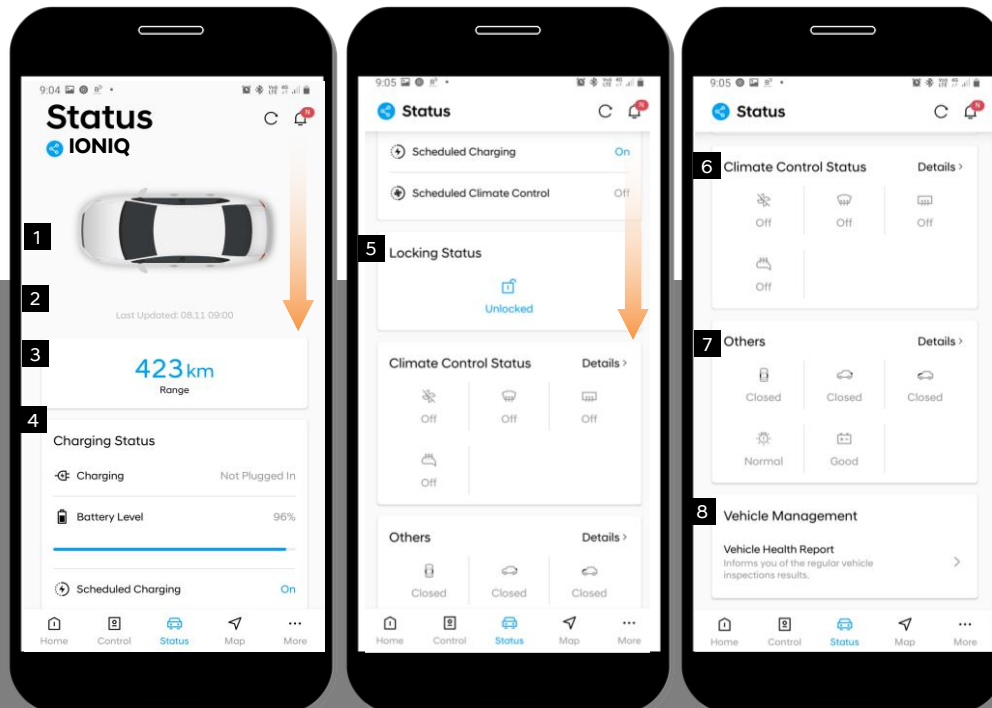

1	Vehicle status top view	Display the customer's current vehicle status in a top view
2	Last Update	Displays the date the vehicle status was last updated
3	Range	Displays the vehicles range based on the amount of battery level remaining
4	Charging Status	Displays charging status, battery level, scheduled charging and climate control
5	Locking Status	Displays if vehicle is locked or unlocked
6	Climate Control status	Displays air conditioning and demister status
7	Others	Displays status of vehicle doors, battery, bonnet, etc.
8	Vehicle Management	Report providing monthly vehicle Health and Status information

6. Status > Car Top View

- Vehicle top view displays the status of vehicle doors (open/closed), bonnet and boot (tailgate).
- Vehicle status is displayed according to the options supported by the vehicle.

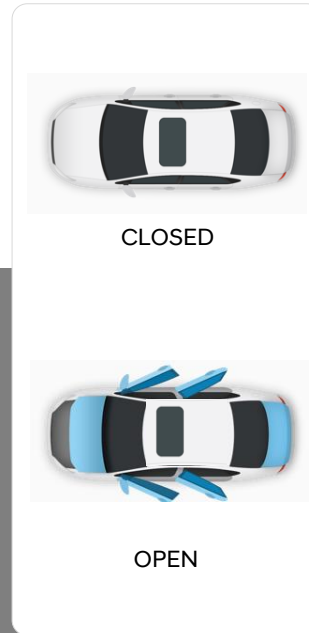
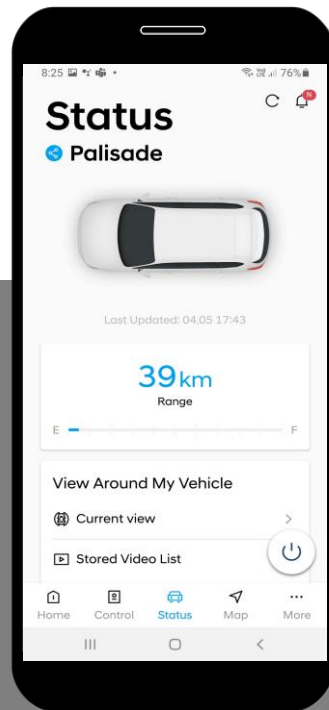

Sedan

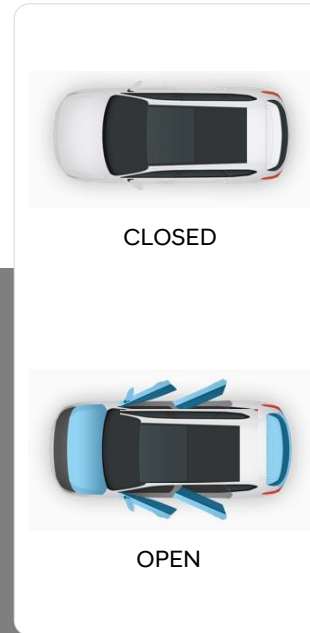

SUV

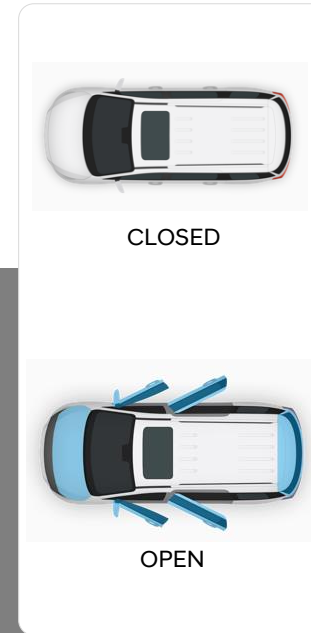

MPV

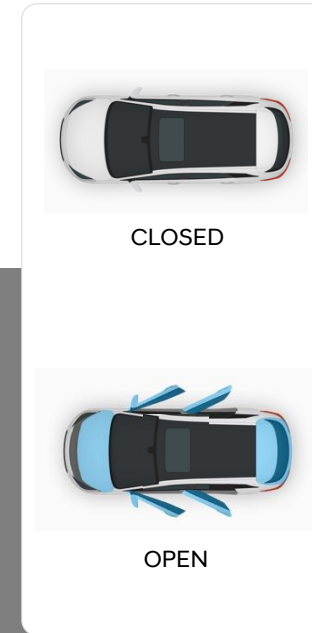

Hatch back

6. Status > View Around My Vehicle

- If cameras are fitted to your vehicle, the 'View Around My Vehicle' box is displayed on the vehicle status screen.
- When entering the menu, you can view the images around your vehicle according to the camera angle.
- In addition, saved images are provided as a list, and you can select and view videos according to the date and time.

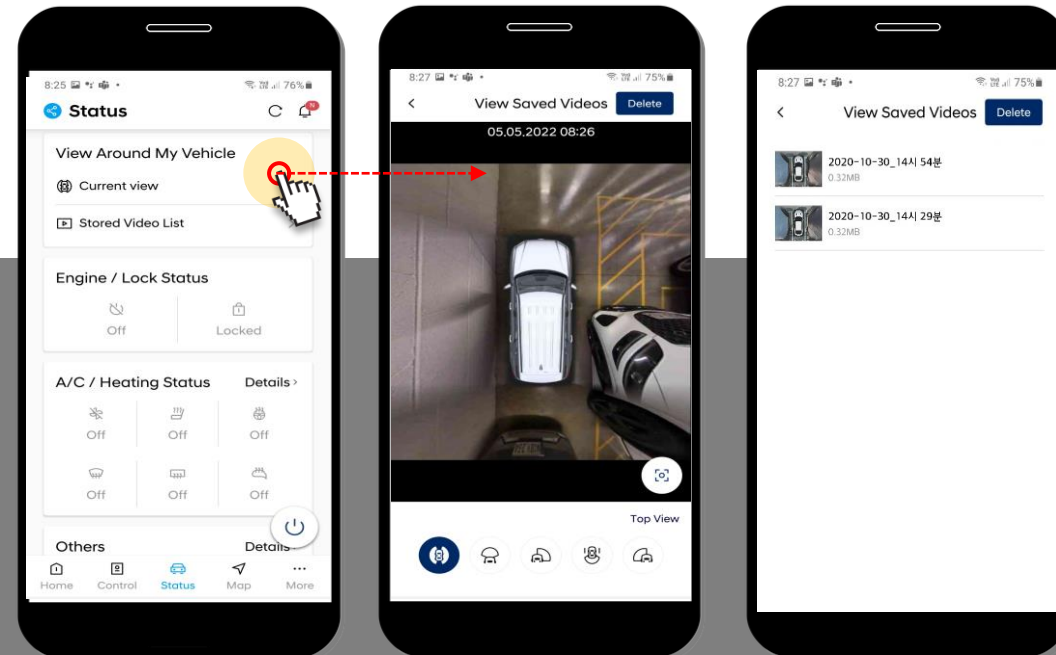

7. Map

- Main screen
- Find my location
- Find my car
- Driving distance radius
- Recent
- Search nearby
- Search process
- Send to car

7. Map > Main

- The map area can be maximized or minimized to suite your search criteria.

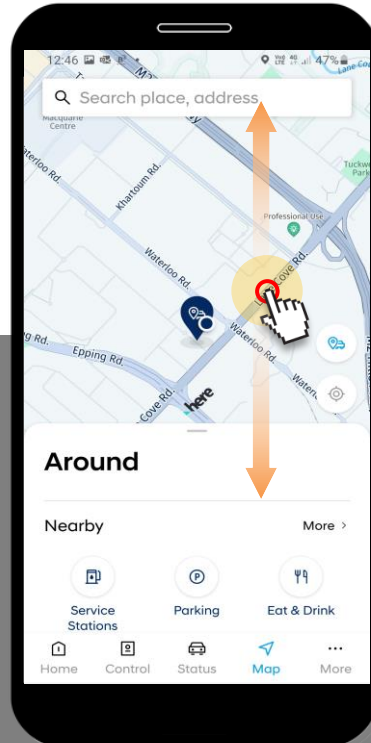

Map main screen
Area can be adjusted by
scrolling up or down.

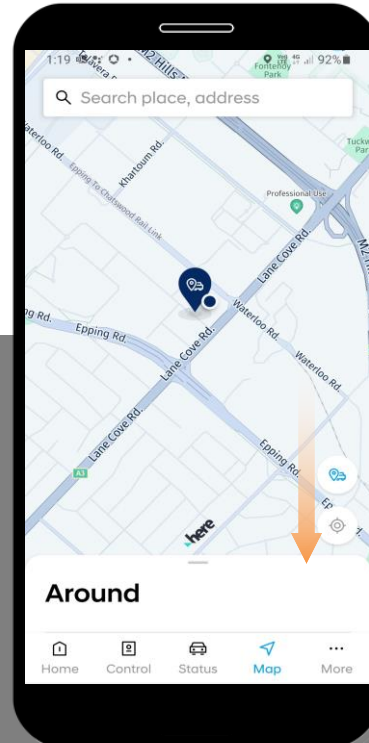

Maximise the map area by
dragging the information
area towards the bottom.

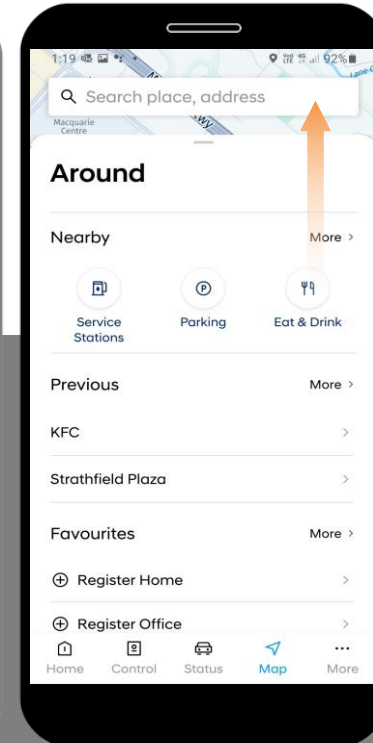

Maximize the bottom
information area to enable
nearby/previous search
and favorite functions.

7. Map > Find my location

- By selecting the Current Location button on the map and using your smartphones GPS, the map will recenter to display your current location, identified on the map by a blue circular icon.

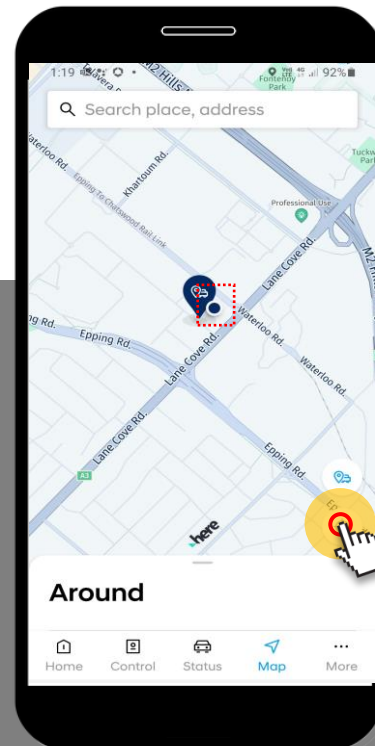

7. Map > Find my car

- If you select the Find My Car Location button on the map, the location of your vehicle will be displayed on the map. You need to enter the 4-digit PIN number set by the user (Only available if vehicle is within 3km from your current location).

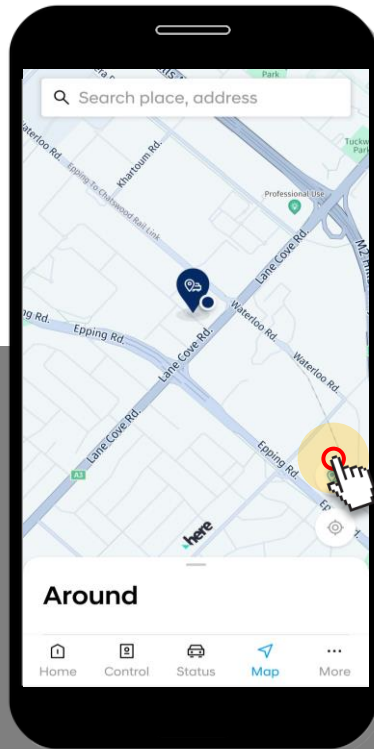

Touch icon to find my car location.

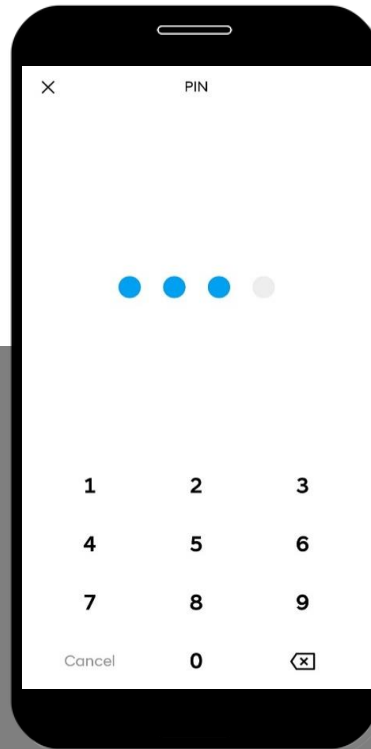

Enter 4-digit PIN number.

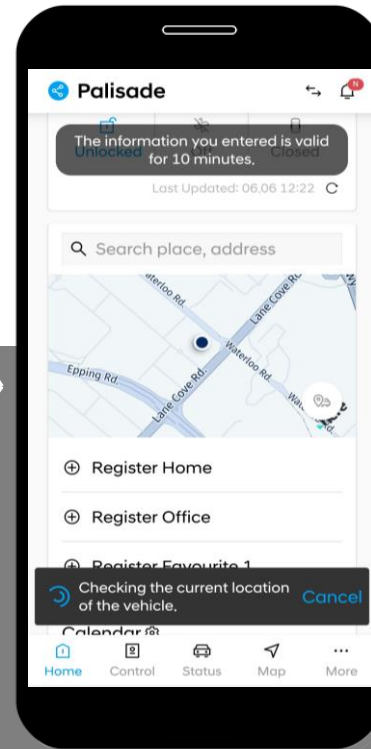

Displays pop up message while searching.

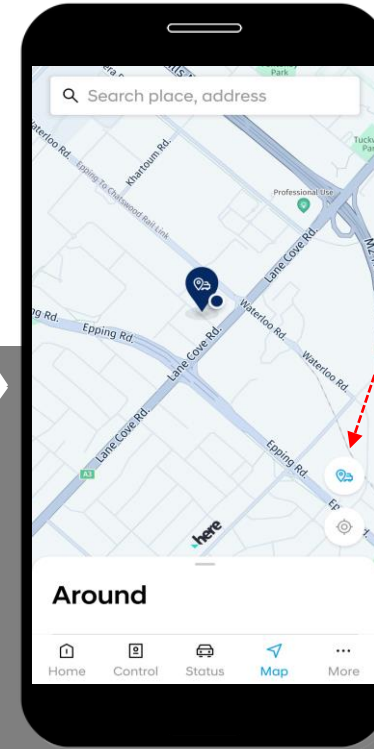

Success to find my car location.

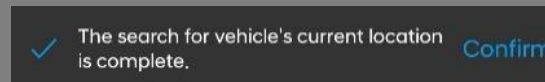

Pop up message displays to confirm vehicle search is complete.

7. Map > Driving Distance Radius

- If you select the Driving Distance Radius button on the map, the range and the driving radius of your vehicle will be displayed on the map. (The find the vehicle location must be on for the driving distance radius function to work).

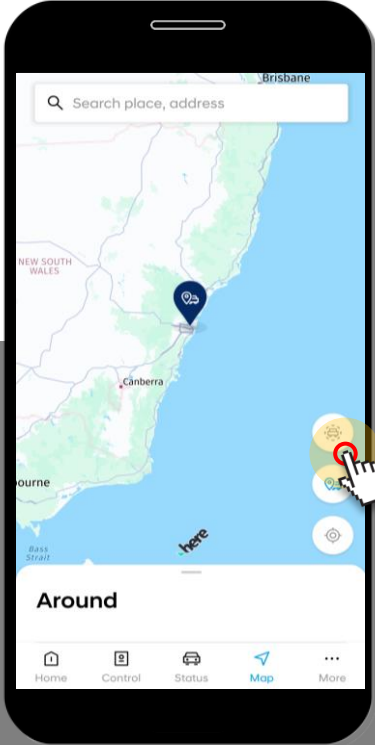

Touch icon to find my car location.

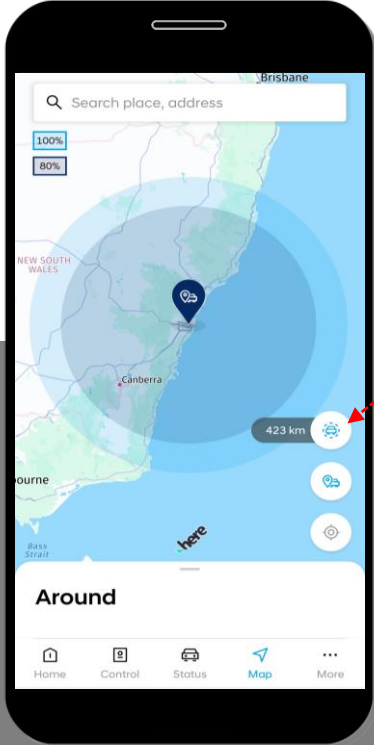

Driving distance radius displayed (80% and 100%)
Range is also displayed.

Driving Distance Radius feature turned off Driving Distance Radius feature turned on

7. Map > My vehicle location

- If you touch the vehicle icon on the map, you can see the address of the vehicle's location and you can use the Augmented Reality (AR) guidance to guide you to your vehicle.

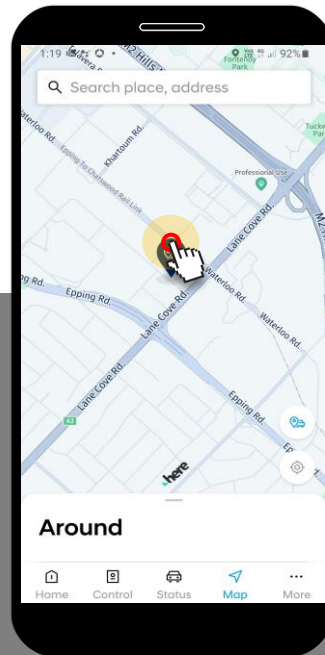

Touch my car icon on the map.

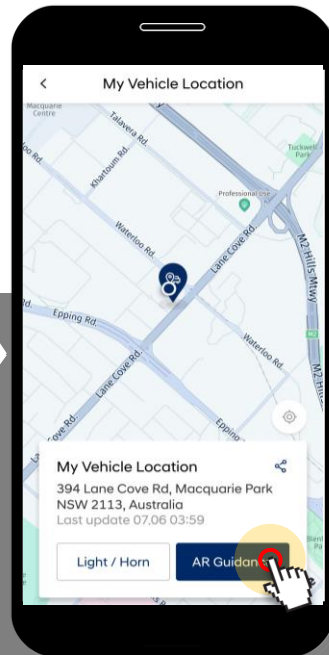

Displays detailed location of your vehicle's location. Select either AR guidance to find your vehicle or trigger Light/Horn if nearby.

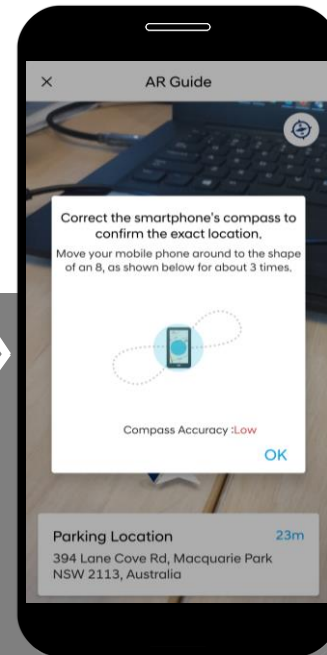

Provides smartphone compass accuracy adjustment function to improve location accuracy (Android Only).

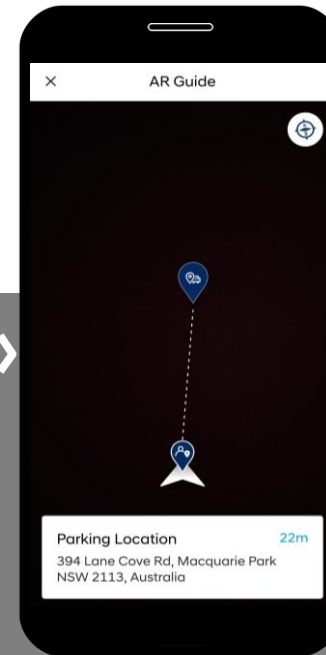

Provides guidance from user location to vehicle location in AR mode. (Provides a straight-line distance from your location to the vehicle).

7. Map > Previous

- You can use integrated search, nearby search, destinations you recently searched for, and favorites.
- In addition, when connected to the vehicle navigation system, you can use recent searches, favorites, and registrations stored in the vehicle navigation system.

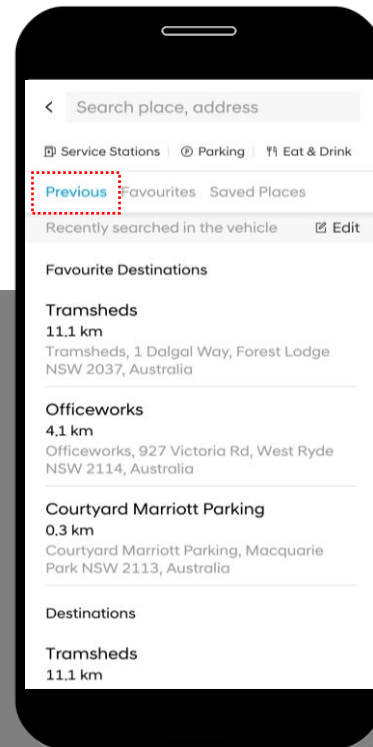

Previous search results are displayed.

7. Map > Search nearby

- Selecting a search category at the bottom of the map main screen displays a list of nearby searches for that category.
- You can search for nearby Service/Charging Stations, Parking and Eat & Drink POI based on your location.

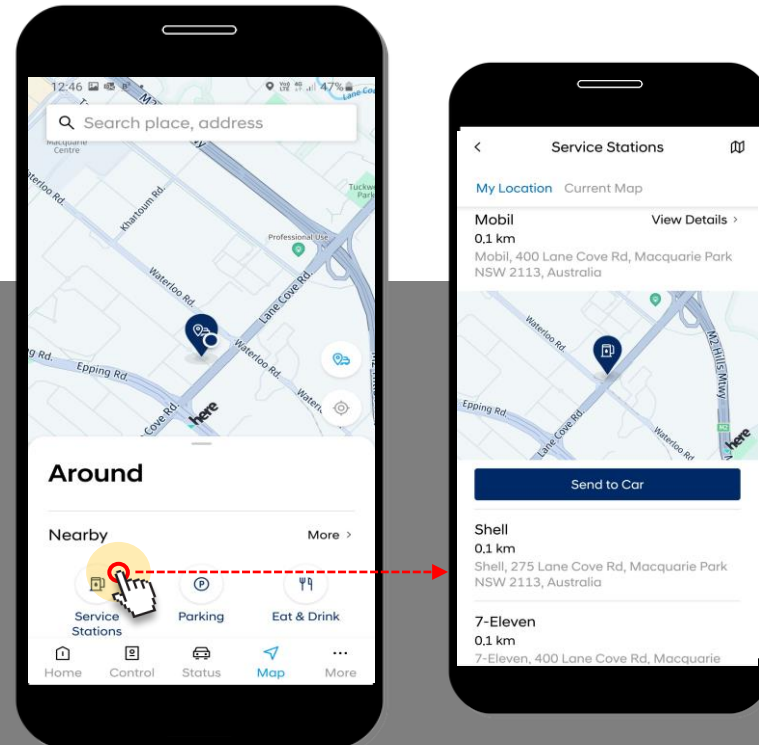

Map main screen.
Select a search category.

Example: Service stations.

7. Map > Search process 1/2

- If you select the search area at the top of the Map screen, you can search for a desired location and display detailed information about the selected destination.

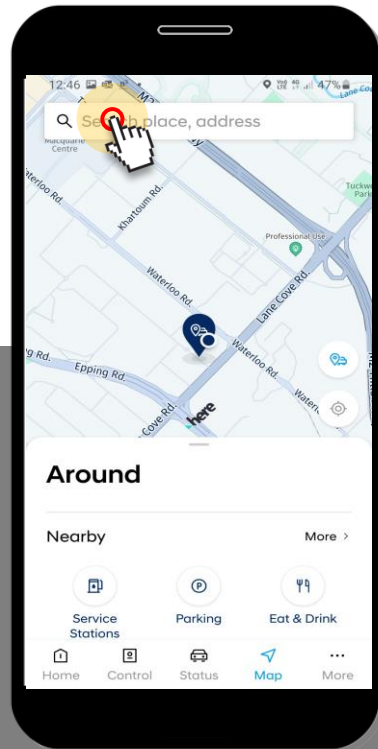

Begin a search in the search area.

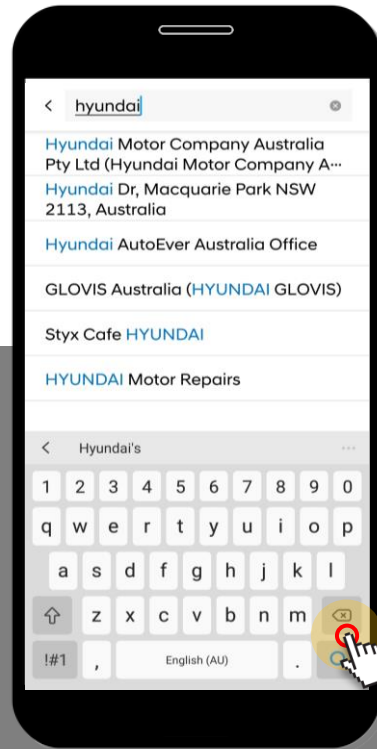

Automatic completion of search according to the search criteria.

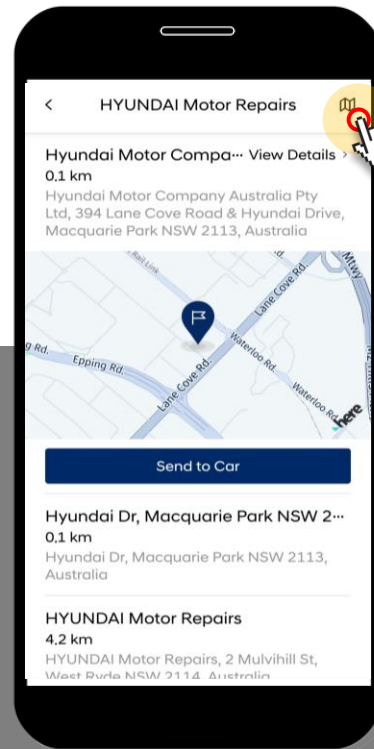

List view search results and map view movement.

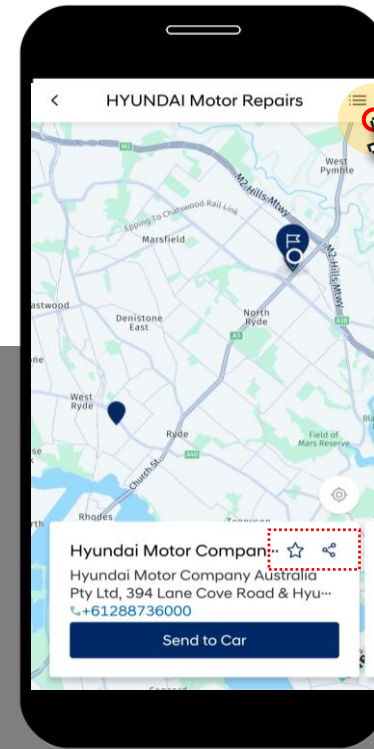

Map view search results and list view movement.



Register favorites

Search results can be registered as favorites by selecting the star icon.



Share search results

When you want to share your search results with others, you can share them via the various sharing apps on your phone.

7. Map > Search process 2/2 swipe through destination - search this area on map

- If you select the search area at the top of the Map screen, you can search for a desired location and display detailed information about the selected destination.

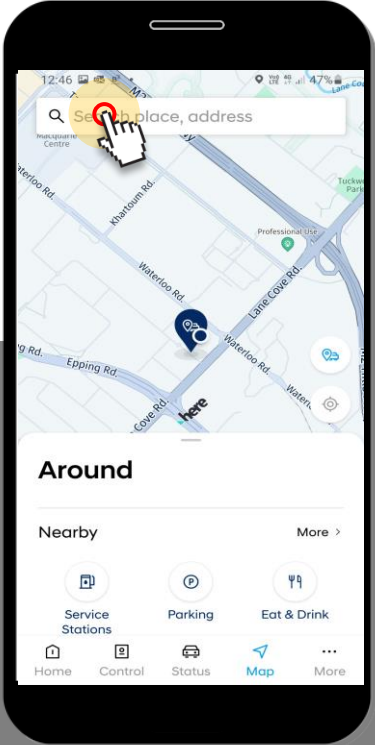

Begin a search in the search area.

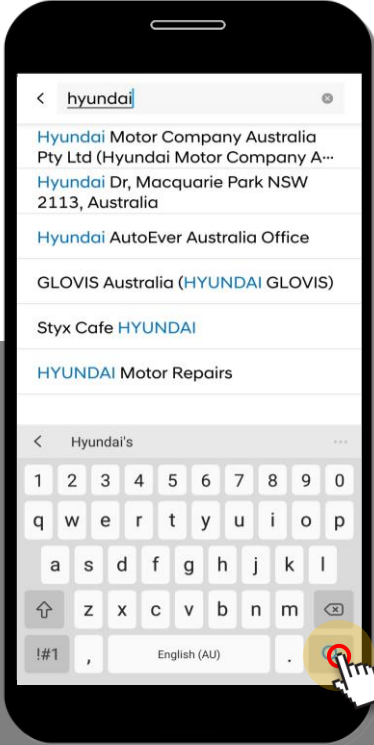

Automatic completion of search according to the search criteria.

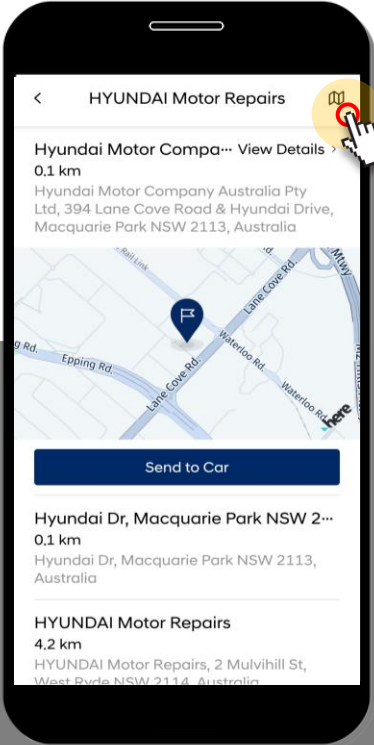

List view search results and map view movement.

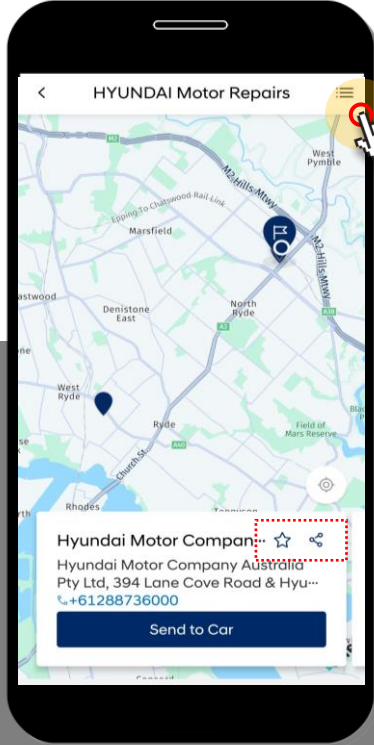

Map view search results and list view movement.

- Maps> Parking> Click on map search this area >Swipe through results > Send to Car



Register favorites
Search results can be registered as favorites by selecting the star icon.



Share search results
When you want to share your search results with others, you can share them via the various sharing apps on your phone.

7. Map > Send to Car

- Once you have found your desired location using the Bluelink™ app, you can send the location details to the car ready for when you begin your journey.
- The location details will appear on the vehicle navigation display when the vehicle is turned on.

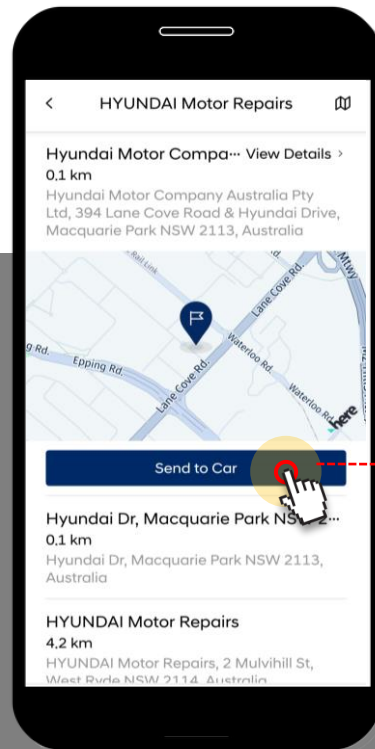

Enter a search term in the search area.

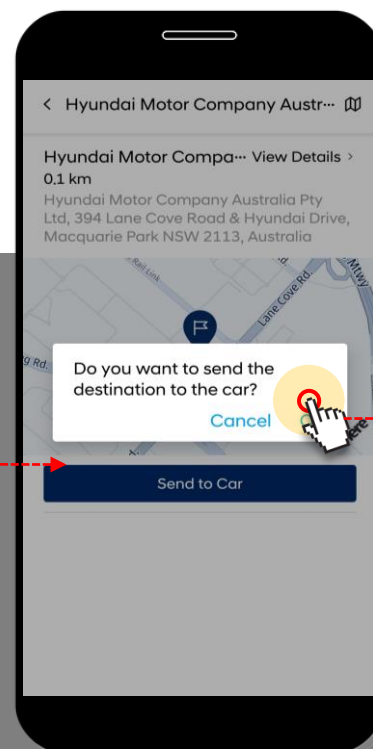

Confirm you want to send the location to the vehicle.



Location will appear on the navigation display.



8. More

- Main screen
- Account Setting
- Vehicle & Service Setting
- Vehicle Selection
- App setting
- My Trips
- Alert Services
- EV services
- Customer Service Center

8. More > Main screen

- The More screen allows you to change app settings and view subscription information.
- In addition, you can view app tutorials and FAQ's.

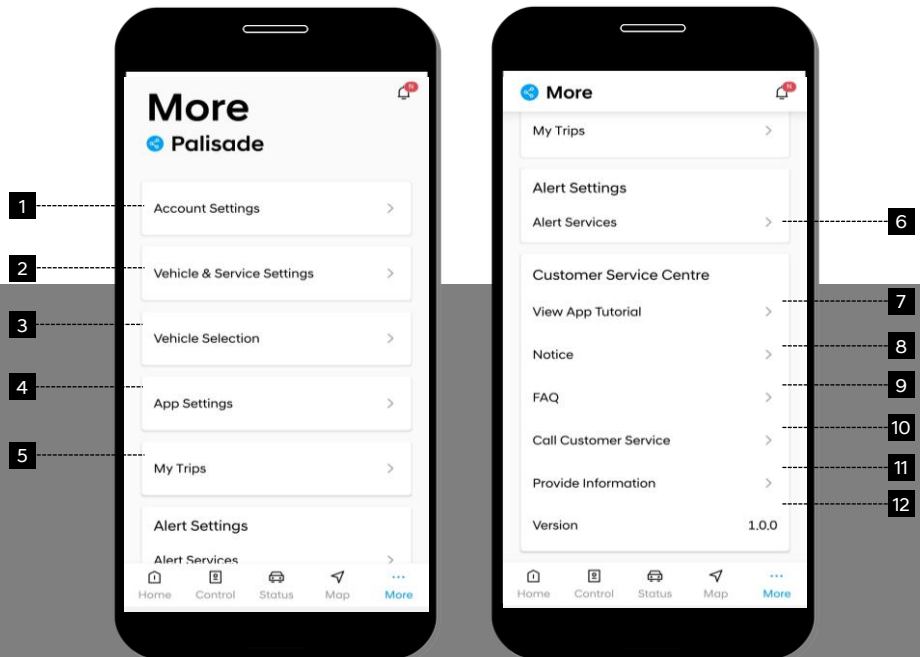

1	Account Setting	Select Account Settings
2	Vehicle & Service Setting	Select Vehicle & Service Settings
3	Vehicle Selection	Add or change vehicles or request to share A vehicle
4	App Settings	Move to the app's main settings screen
5	My Trips	Move to My Trips screen to view selected trips by date
6	Alert Settings	Set various alert settings
7	View App Tutorial	Tutorials for Bluelink™ common functions
8	Notice	Displays app notices
9	FAQ	Displays Frequently Asked Questions
10	Call Customer Service	View or call the Customer Call number
11	Provide Information	Open-Source License
12	Version	App development version information

8. More > Main screen

- The More screen allows you to change app settings and view subscription information.
- In addition, you can view app tutorials and FAQ's.

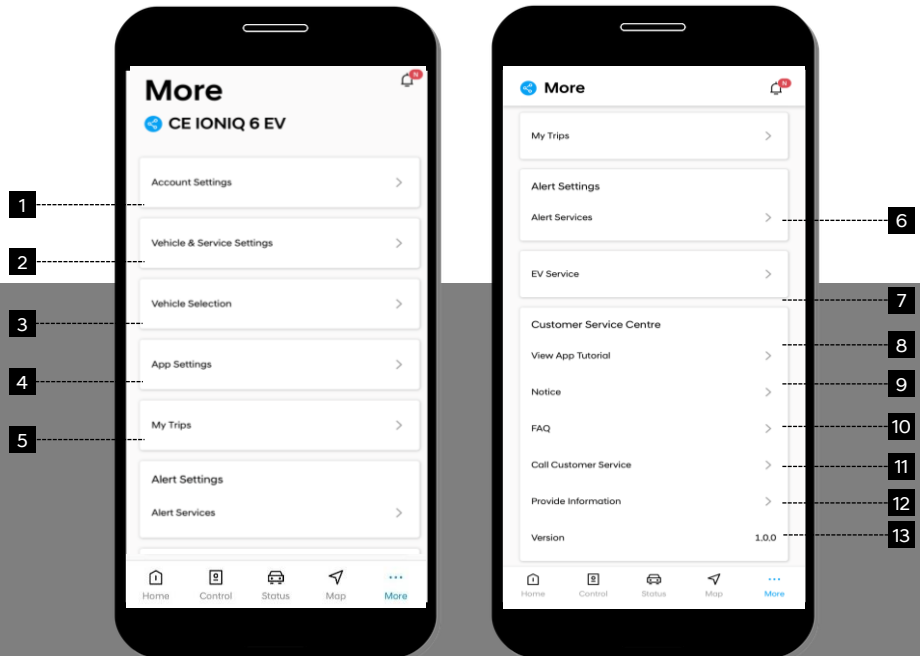

1	Account Setting	Select Account Settings
2	Vehicle & Service Setting	Select Vehicle & Service Settings
3	Vehicle Selection	Add or change vehicles or request to share A vehicle
4	App Settings	Move to the app's main settings screen
5	My Trips	Move to My Trips screen to view selected trips by date
6	Alert Settings	Set various alert settings
7	EV Service	Set various alert settings
8	View App Tutorial	Tutorials for Bluelink™ common functions
9	Notice	Displays app notices
10	FAQ	Displays Frequently Asked Questions
11	Call Customer Service	View or call the Customer Call number
12	Provide Information	Open-Source License
13	Version	App development version information

8. More > Account Setting

- On the account setting screen, you can:
 1. Change and reset your PIN for remote & location features
 2. Change your password used when logging in
 3. Reset your Account
 4. Terminate your Account

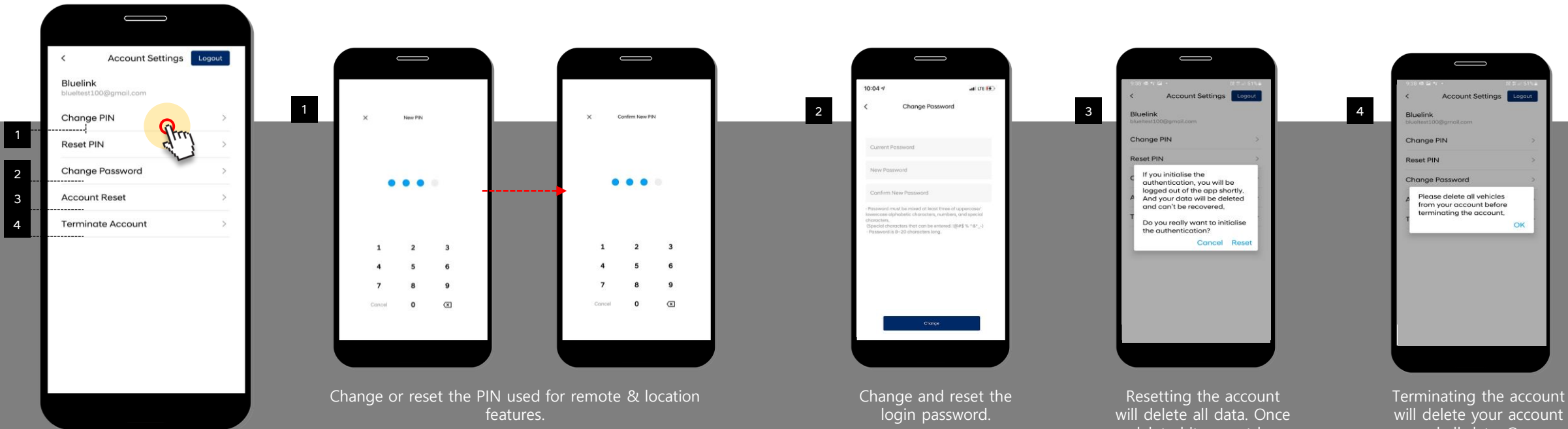

User's account information, login password and account password can be set.

Change or reset the PIN used for remote & location features.

Change and reset the login password.

Resetting the account will delete all data. Once deleted it cannot be retrieved.

Terminating the account will delete your account and all data. Once deleted it cannot be retrieved and you will need to create a new account.

8. More > Vehicle & Service Setting (1/2)

- Change the name of your vehicle
- View subscription information
- Add or remove users sharing your car and manage car sharing settings.
- Incorporate your personal Google or iCloud calendars into the app.

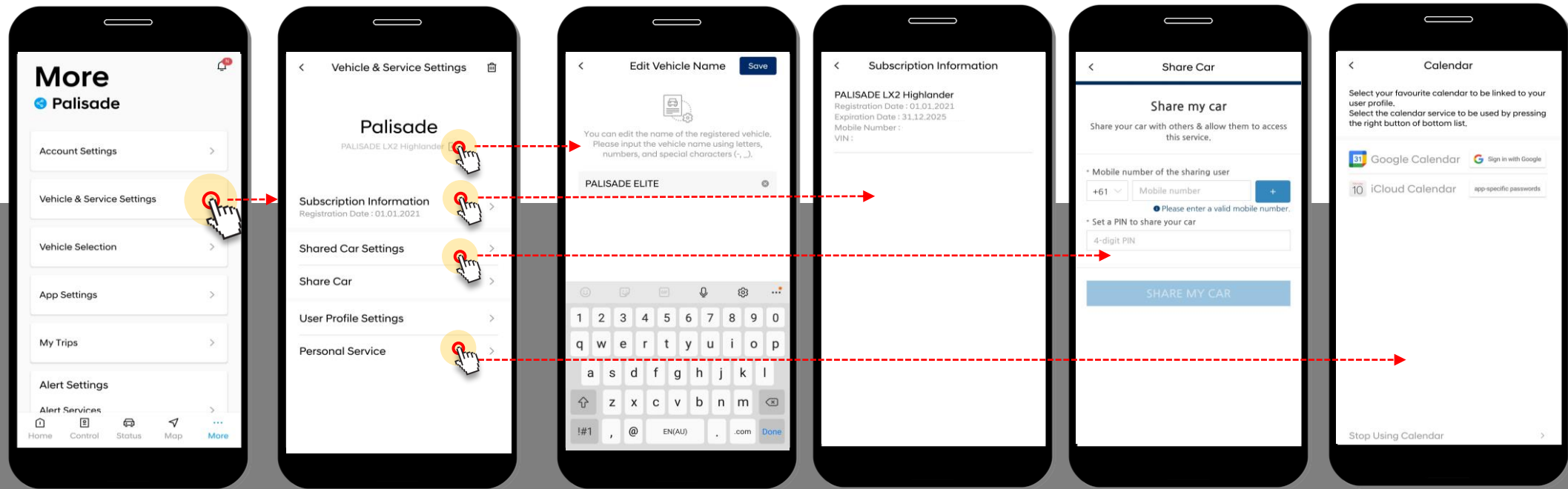

Vehicle & Service Settings screen.

Edit vehicle name.

User's subscription information.

Share Car screen where you can share your vehicle with family or friends.

Incorporate your personal calendars with the BlueLink™ app.

8. More > Vehicle & Service Setting (2/2)

- User Profile Settings allows you to:
 1. Backup your User Profile.
 2. Add an image avatar to your profile.
 3. Configure your vehicle settings.
 4. Link a Driver Account for use across multiple vehicles.

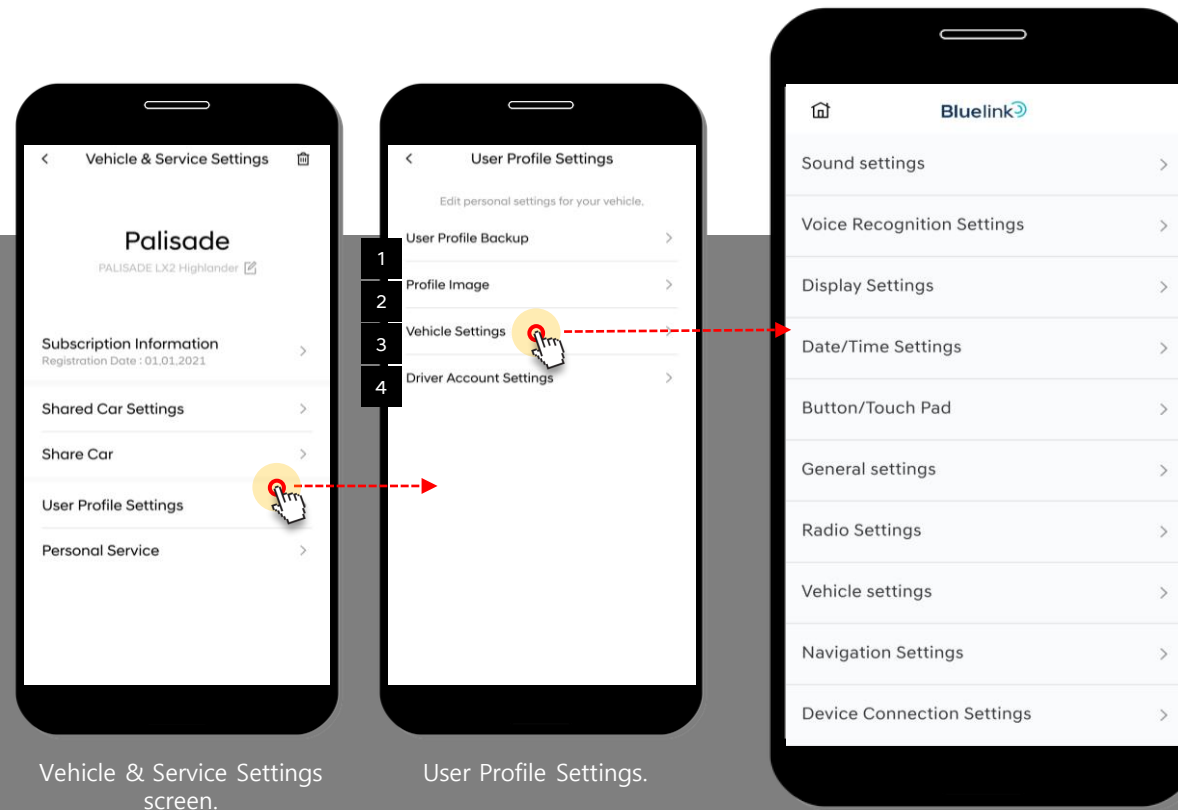

Vehicle & Service Settings screen.

User Profile Settings.

Vehicle Setting Screen allows you to configure the above vehicle features and save your changes.

8. More > Vehicle Selection

- If you have more than one Hyundai linked to your account, you can change between vehicles from the vehicle selection screen.
- If you have a shared Hyundai linked to your account, you can also select it from this screen.

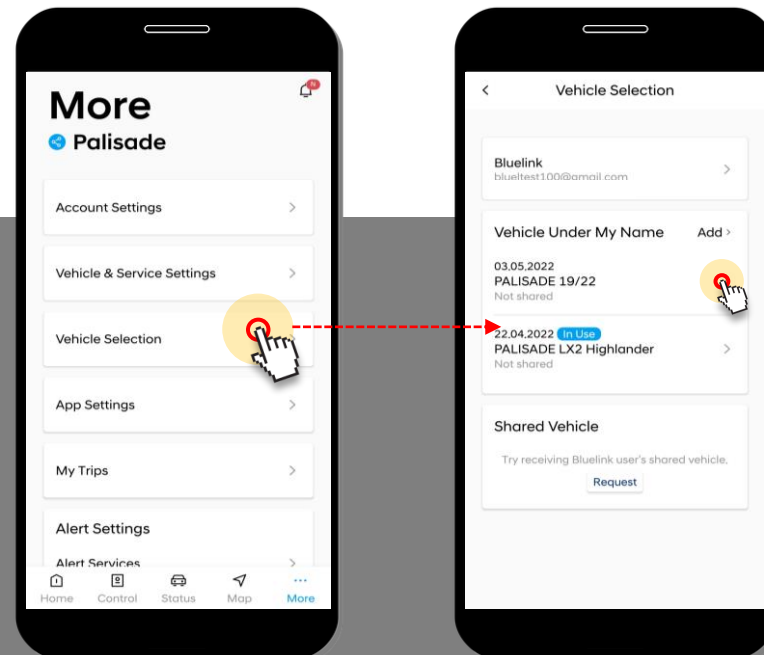

8. More > App Setting

- Allows you to configure the main functions and settings of the Bluelink™ app.

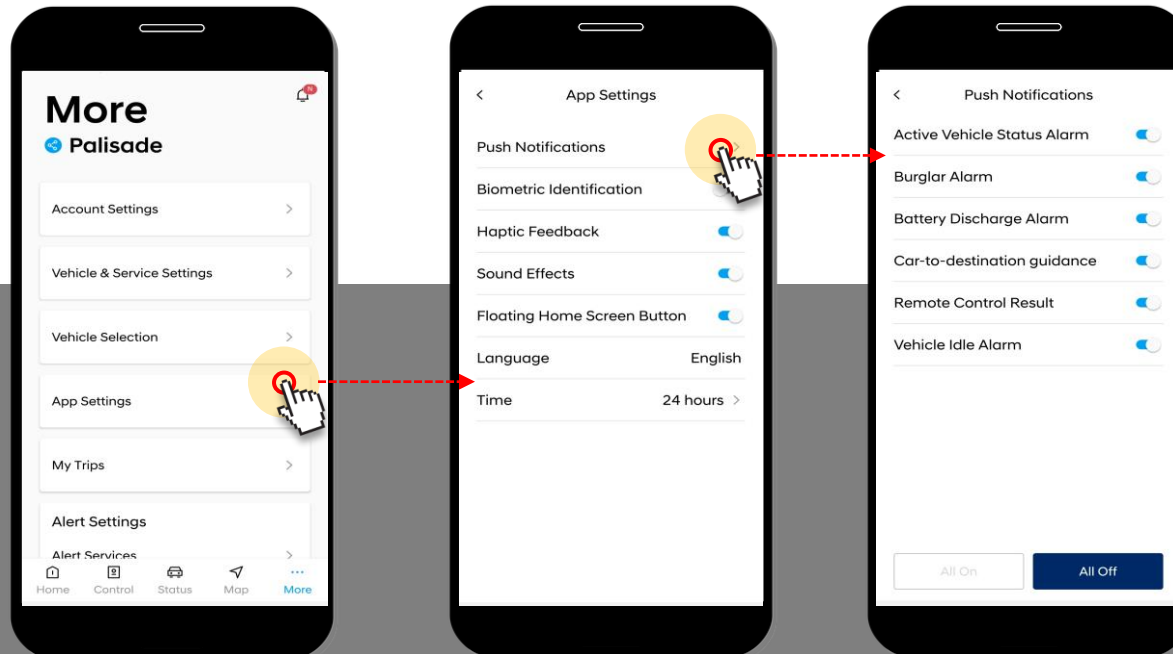

Enable or disable the following notifications:

1. Active Vehicle Status Alarm
2. Burglar Alarm
3. Battery Discharge Alarm
4. Car-to-destination guidance
5. Remote Control result
6. Vehicle idle Alarm

App Settings allows you to:

1. Configure with notifications you want to receive.
2. Enable/disable Biometric identification
3. Enable/disable Haptic Feedback
4. Enable/disable Sound Effects for remote functions
5. Enable/disable the Floating Home Screen Start Button
6. Displays Language
7. Select either 24h or 12h time.

8. More > App Setting

- Allows you to configure the main functions and settings of the Bluelink™ app.

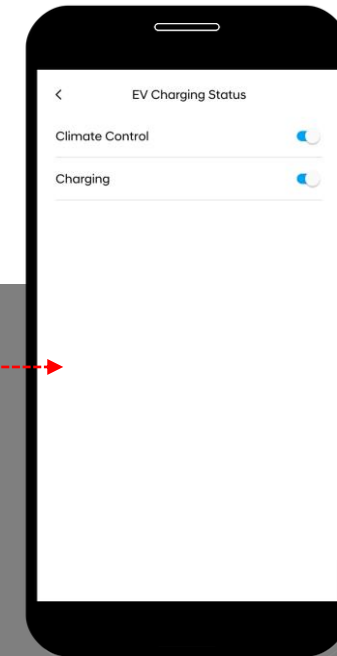
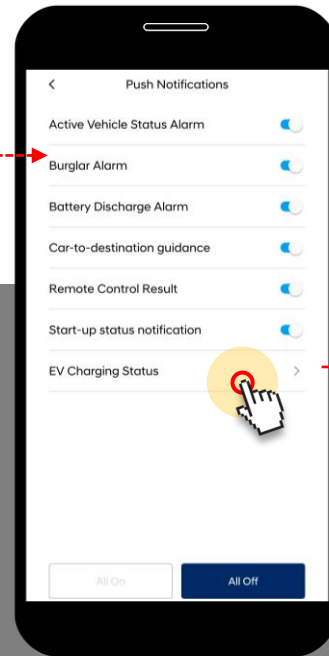
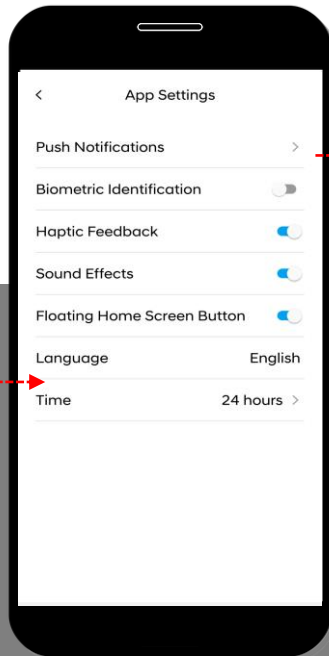
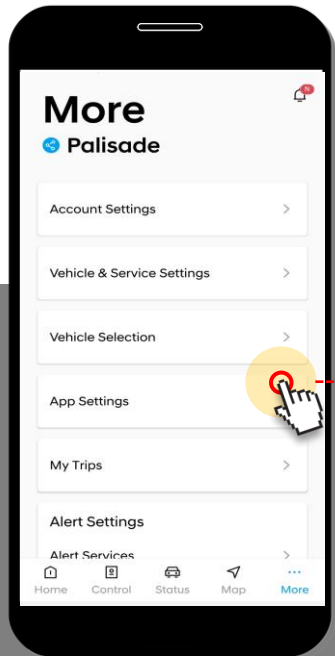

App Settings allows you to:

1. Configure with notifications you want to receive.
2. Enable/disable Biometric identification
3. Enable/disable Haptic Feedback
4. Enable/disable Sound Effects for remote functions
5. Enable/disable the Floating Home Screen Start Button
6. Displays Language
7. Select either 24h or 12h time.

Enable or disable the following notifications:

1. Active Vehicle Status Alarm
2. Burglar Alarm
3. Battery Discharge Alarm
4. Car-to-destination guidance
5. Remote Control result
6. Start-up status notification
7. EV Charging Status

Enable or disable the following notifications:

1. Climate Control
2. Charging

8. More > My trips

- You can view monthly driving information for any given month.
- You can view driving time, distance travelled, average speed and top speed by date and by trip.

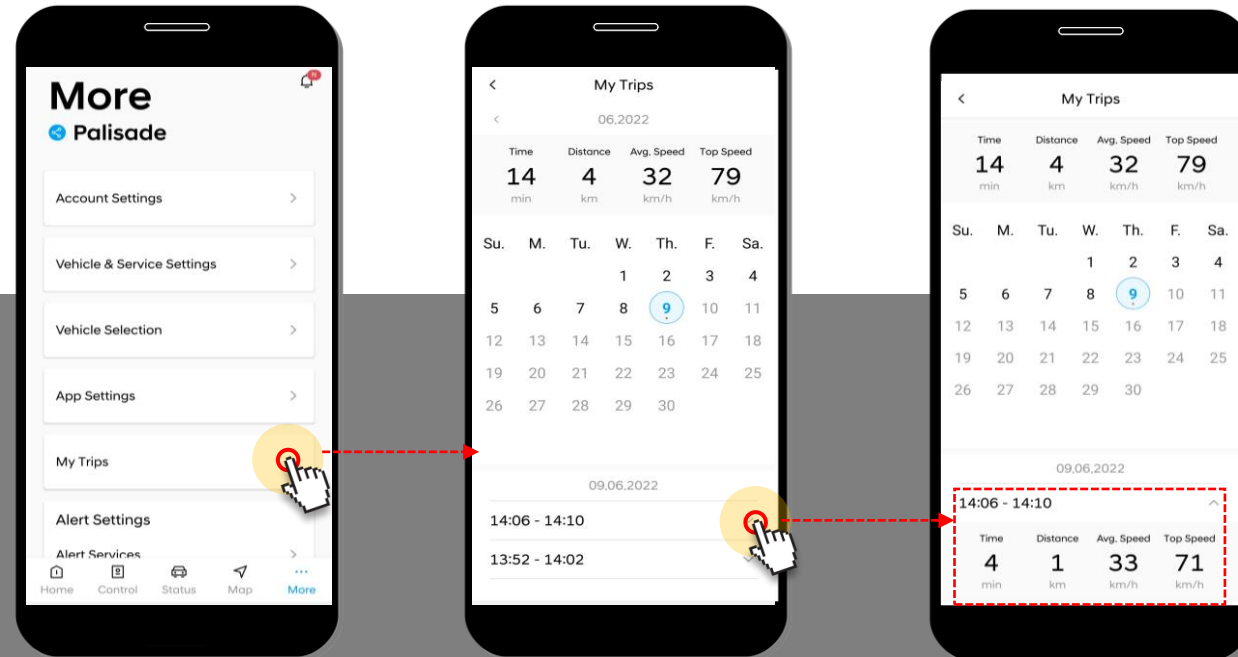

More > My Trips

- Select the desired date and trip

- Trip details are displayed

8. More > EV Services

- Set charging limits and view energy consumption breakdown of vehicle.

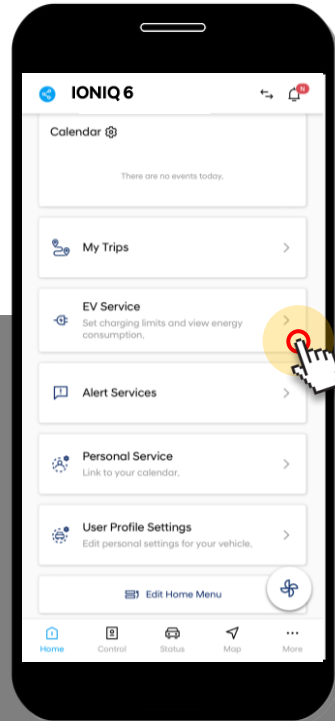

Select EV Service.

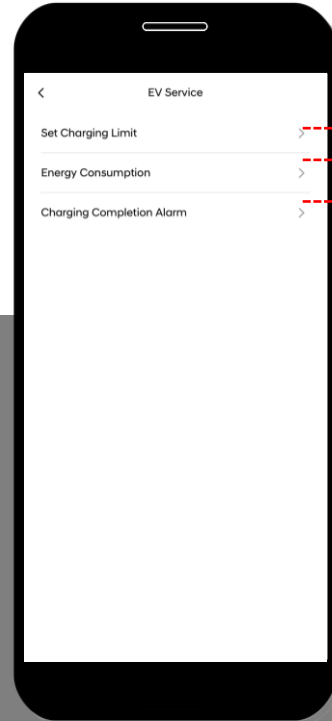

Select set charging limit.

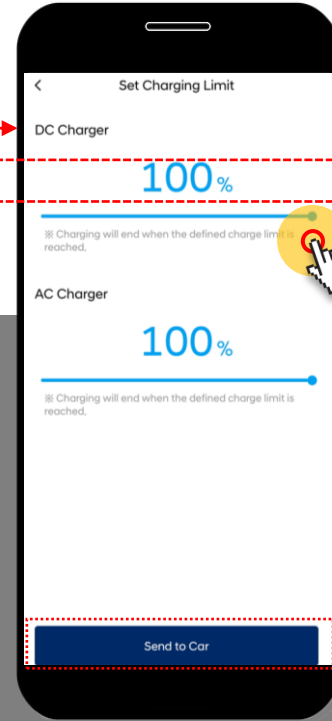

Set DC and/or AC charge limit (50 - 100%).
Send to Car.

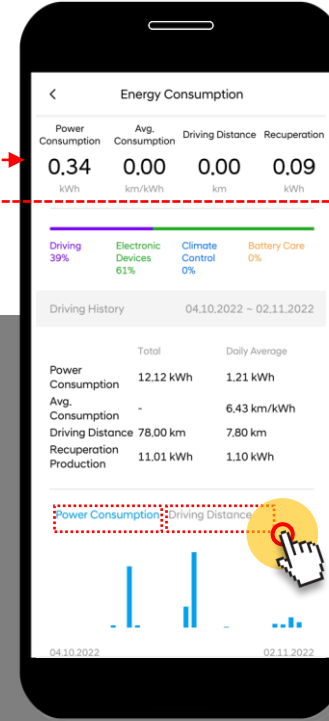

View breakdown of energy consumption and driving distance.

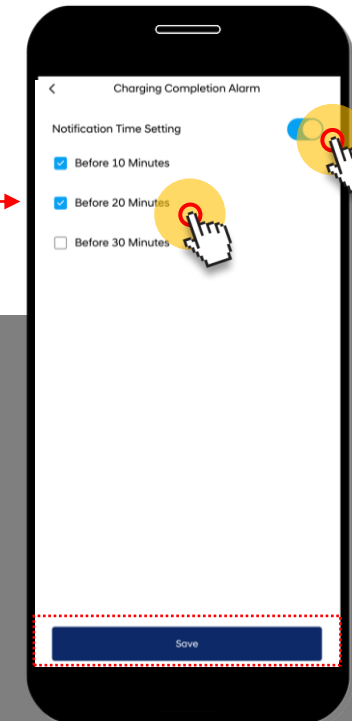

Set completion alarm by turning on the notification time setting and picking one or multiple alerts.

8. More > Alert Service > Valet Alert

- Whenever you leave your Hyundai vehicle with a valet driver, you can set the Valet Alert to notify you if your vehicle travels beyond your chosen distance and if Idle time and speed has been exceeded.
- The distance allowed is from the location where the alert was activated. You can manage detailed valet settings from within the Bluelink™ app.

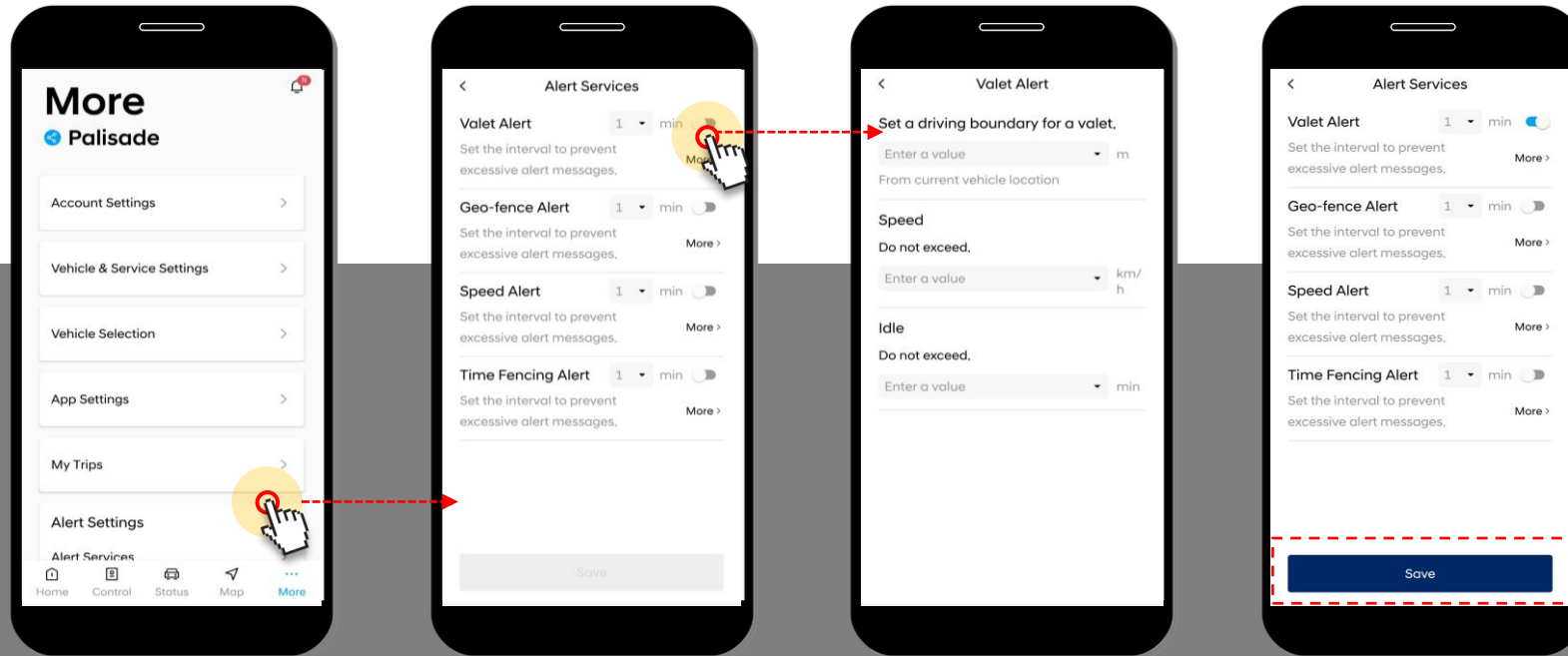

More > Alert Service

Alert Service – Main
• Enable Valet Alert

Valet Alert
• Set boundary, speed and idle time

Save Changes

8. More > Alert Service > Geofence Alert

- This feature allows you to set a boundary from a chosen central location for your vehicle.
- You will be notified if your vehicle travels outside the chosen boundary.

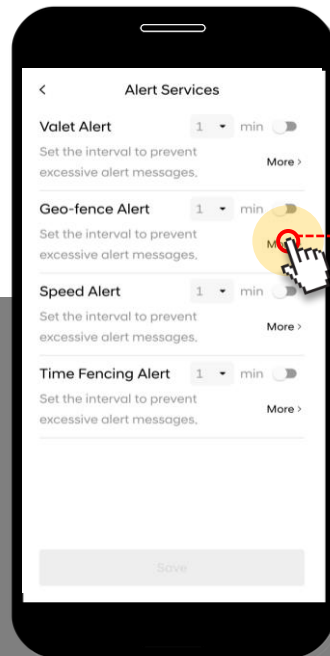

Alert Service – Main
• Enable Valet Alert

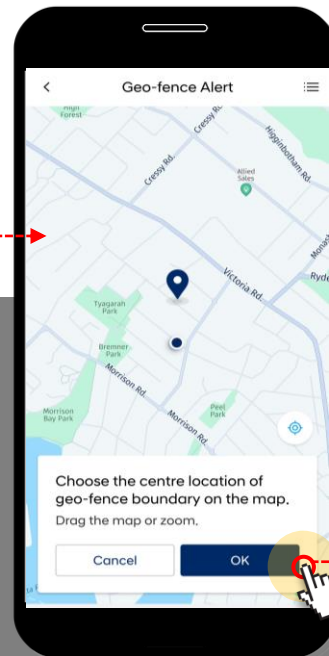

Geofencing Alert
• Select centre of geo-fence boundary

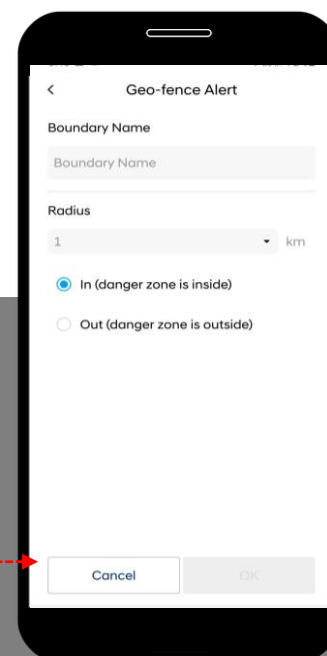

Add new geofence alert

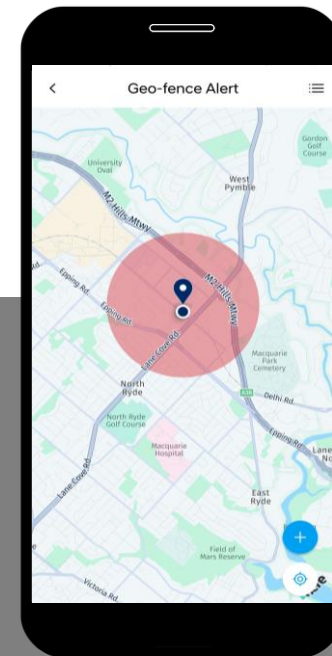

New Geo-fence Completed

8. More > Alert Service > Speed Alert

- This feature allows you to pre-set a speed limit for your vehicle.
- You will be notified if your vehicle exceeds this speed limit.

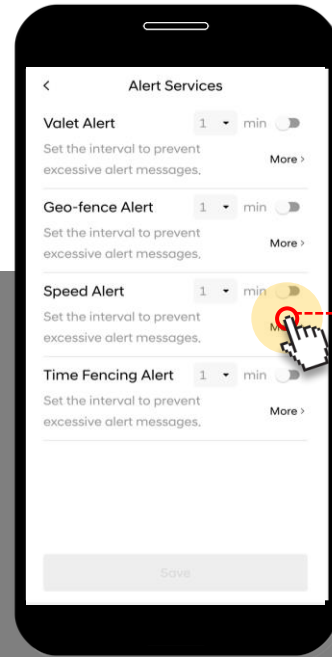

Alert Service – Main
• Enable Speed Alert

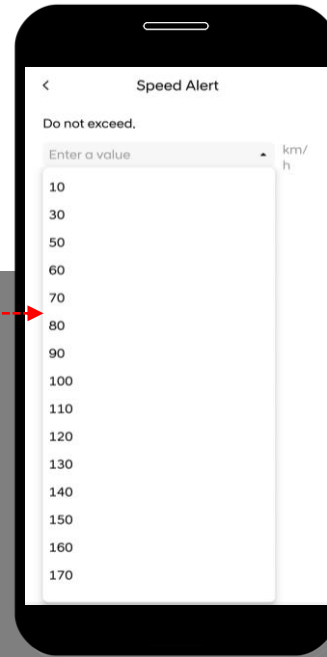

• Select desired speed

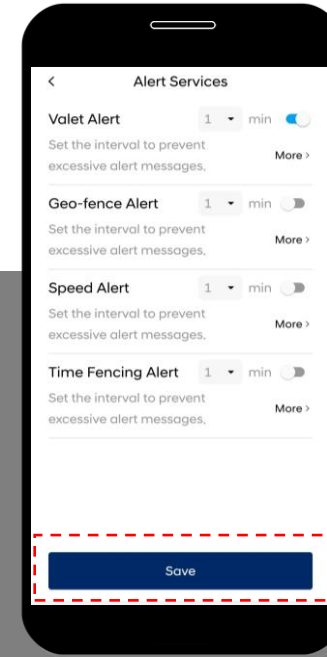

Save Changes

8. More > Alert Service > Time Fencing Alert

- This feature allows you to pre-set time intervals for when your Hyundai vehicle can and cannot be driven.
- You will be notified if these curfews are exceeded.

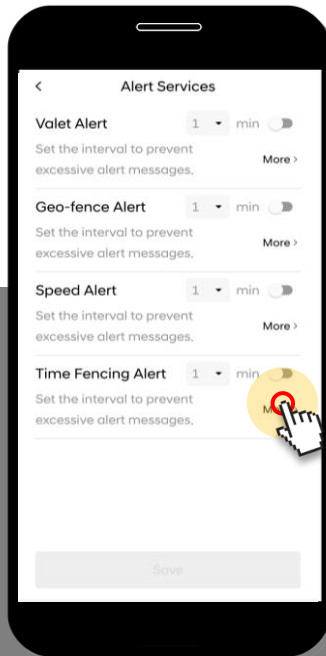

Alert Service – Main

- Time Fencing Alert

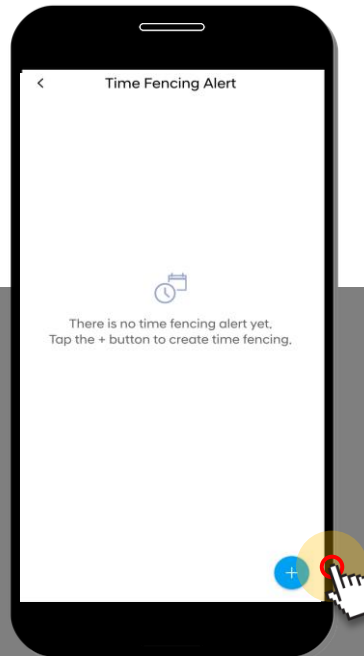

Add new time-fencing alert

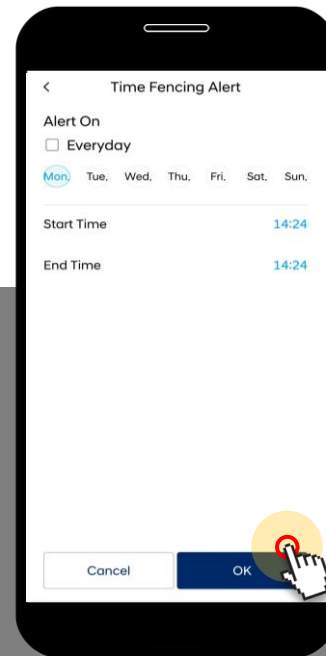

Select occurrence & time

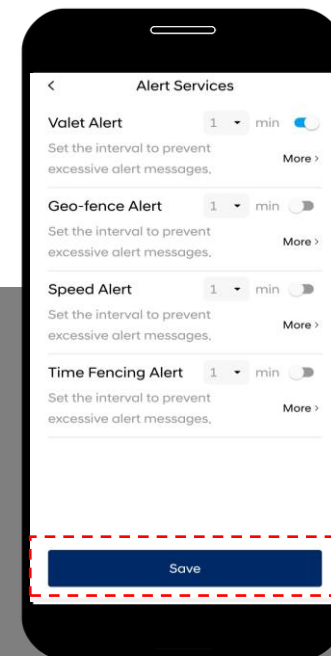

Completed adding new alert

8. More > Customer Service Center

- In the customer service center, you can find information including the call centre contact details, app version and tutorials plus some frequently asked questions (FAQ).

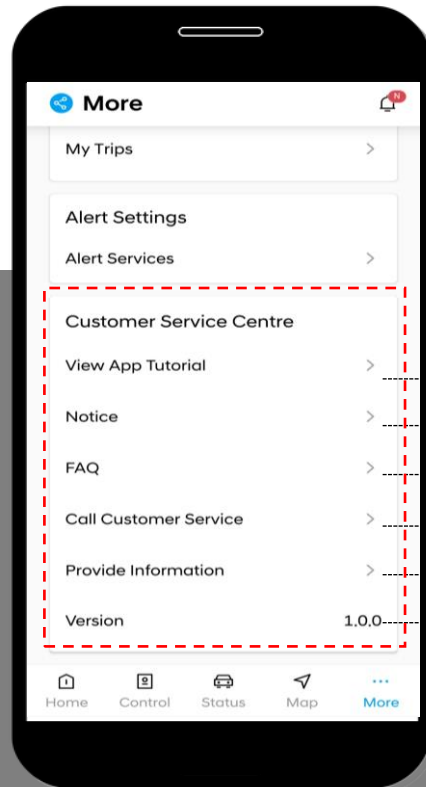

1	View App Tutorial	Tutorials for Bluelink™ common functions
2	Notice	Displays app notices
3	FAQ	Displays Frequently Asked Questions
4	Call Customer Service	View or call the Customer Call number
5	Provide Information	Open-Source License
6	Version	App development version information